

SG1404

 Shaft dia.(轴径) $\phi 14$ Lead(导程) 4mm

C3&C5

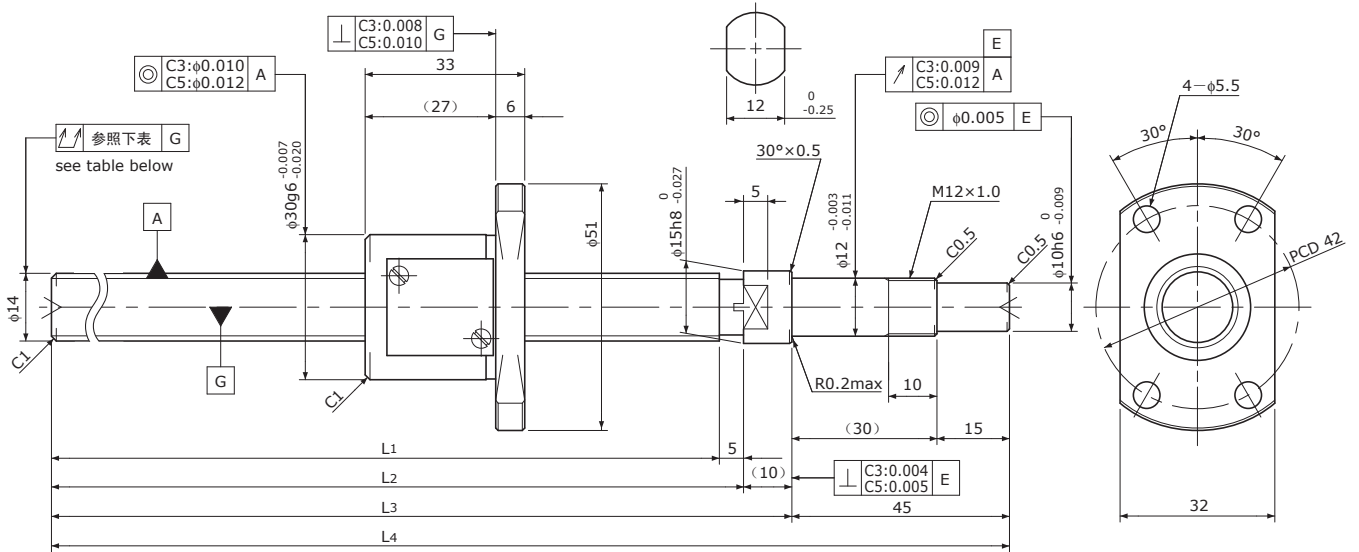

Unit(单位): mm

Ball Screw Specifications 主要技术参数	
Ball size 钢珠直径	$\phi 2.381$
Number of thread 螺纹条数	1
Thread direction 螺纹旋向	Right 右旋
Shaft root dia. 丝杠轴底径	$\phi 11.8$
Number of circuit 循环数	3.7×1
Shaft, Nut material 轴、螺母材质	SCM415H
Surface hardness 螺纹部表面硬度	HRC58~62 (Thread area)
Anti-rust treatment 防锈处理	Anti-rust oil 防锈油

Supported-side end-journal profile 支撑侧轴端加工形状

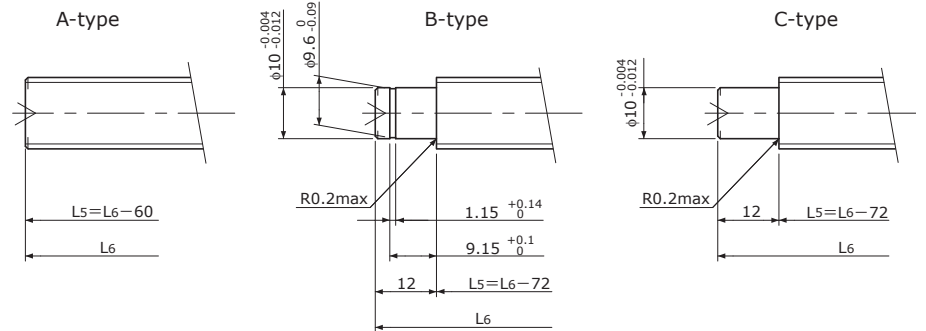

L_5 : Thread length after end-journal machining. 追加加工后的螺纹部长度
 L_6 : Total length after end-journal machining. 追加加工后的总长

Support-unit Recommendation 推荐的支架组件

Supported-side 支撑侧	: EF12
Fixed-side 固定侧	: EK12

D-type : Other than the above. 上述以外的形状

Unit(单位): mm

Ball Screw Model 滚珠丝杠型号	Travel 行程	Grade 精度	Shaft length 丝杠轴长度				Lead accuracy 导程精度		Total Run-out 全跳动	Axial play 轴向间隙	Preload Torque 预压扭矩 Nm	Basic Load Rating 基本额定负载 N	
			L ₁	L ₂	L ₃	L ₄	Travel deviation 代表移动量误差 e_p	Variation 波动 V_u				Dynamic 额定动负载 Ca	Static 额定静负载 Coa
SG1404-190R250C3	155	C3	190	195	205	250	± 0.010	0.008	0.030	0 Spacer Ball 间隔钢珠 (1:1)	0.020~ 0.070	3600	5800
SG1404-240R300C3	205	C3	240	245	255	300	± 0.012	0.008	0.030				
SG1404-290R350C3	255	C3	290	295	305	350	± 0.012	0.008	0.040				
SG1404-390R450C3	355	C3	390	395	405	450	± 0.013	0.010	0.050				
SG1404-490R550C3	455	C3	490	495	505	550	± 0.015	0.010	0.055				
SG1404-190R250C5	155	C5	190	195	205	250	± 0.020	0.018	0.045	~0.005	—	5700	11600
SG1404-240R300C5	205	C5	240	245	255	300	± 0.023	0.018	0.045				
SG1404-290R350C5	255	C5	290	295	305	350	± 0.023	0.018	0.055				
SG1404-390R450C5	355	C5	390	395	405	450	± 0.025	0.020	0.060				
SG1404-490R550C5	455	C5	490	495	505	550	± 0.027	0.020	0.075				

Note) Please refer to p-A206 for order code of end-journal machining. 注) 追加加工的公称型号指定方式请参照p-A206.