

SRT0601

 Shaft dia.(轴径) $\phi 6$ Lead(导程)1mm

Ct7&Ct10

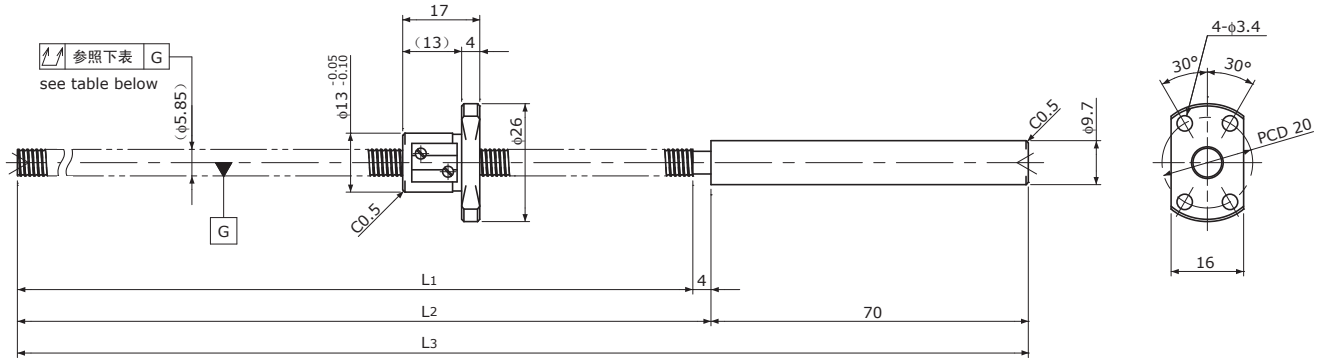

Unit(单位): mm

Ball Screw Specifications		主要技术参数
Ball size	钢珠直径	$\phi 0.8$
Number of thread	螺纹条数	1
Thread direction	螺纹旋向	Right 右旋
Shaft root dia.	丝杠轴底径	$\phi 5.3$
Number of circuit	循环数	3.7×1
Material	Shaft 轴	SCM415H+SUS303
	Nut 螺母	SCM415H
Surface hardness		HRC58~
螺纹部表面硬度		(Thread area)
Anti-rust treatment		Anti-rust oil
防锈处理		防锈油

End-journal profile 轴端加工形状 Supported-side 支撑侧

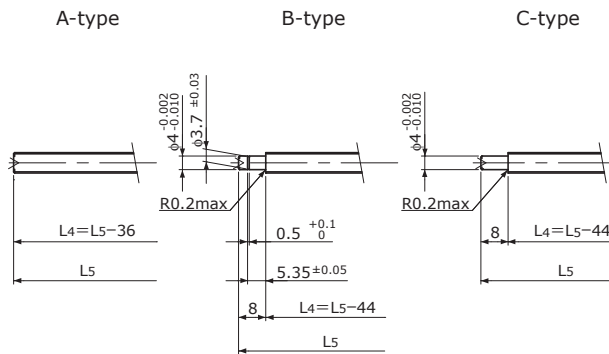

Fixed-side 固定侧

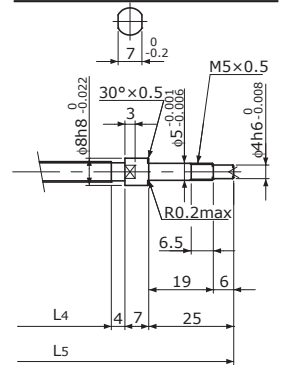

L4: Thread length after end-journal machining. 追加加工后的螺纹部长度
 L5: Total length after end-journal machining. 追加加工后的总长

Support-unit Recommendation	Supported-side	支撑侧	MSU-5CS/5GS, SUP04-S
推荐的支架组件	Fixed-side	固定侧	MSU-5C/5G, EK5

D-type : Other than the above. 上述以外的形状

Unit(单位): mm

Ball Screw Model	Travel	Grade	Shaft length			Lead accuracy		Total Run-out	Axial play	Preload Torque	Basic Load Rating	
			L1	L2	L3	Travel deviation	Variation				Dynamic	Static
滚珠丝杠型号	行程	精度				代表移动量误差	波动	全跳动	轴向间隙	预压扭矩	额定动负载	额定静负载
						e_p	V_{300}	μm		Nm	Ca	Coa
SRT0601-146R220C7	125	Ct7	146	150	220	± 0.02	—	0.080	~0.020	—	680	1200
SRT0601-261R335C7	240	Ct7	261	265	335	± 0.04	—	0.120				
SRT0601-146R220C10	125	Ct10	146	150	220	± 0.10	—	0.160	~0.050	—	680	1200
SRT0601-261R335C10	240	Ct10	261	265	335	± 0.18	—	0.240				

Note) Please refer to p-A287 for order code of end-journal machining. 注)追加加工的公称型号指定方式请参照p-A287.