

## PSR/PSRT 系列 精密冷轧滚珠丝杠 标准库存品

### PSR/PSRT series Precision Rolled Ball Screws

PSR/PSRT 系列 精密冷轧滚珠丝杠 标准库存品。  
冷轧加工的滚珠丝杠实现了精密级 (JIS C5) 的精度。  
为以往的冷轧滚珠丝杠无法满足精度要求的装置提供性价比优越的产品。

#### ●特征

- 以往只能达到Ct7, Ct10 精度的冷轧加工, 我司实现了精密级 (JIS C5) 的精度。
- 备有轴端比丝杠轴粗的台阶型和全螺纹未加工型2种, 给客户提供更多的设计自由度。
- 台阶型轴端比丝杠轴粗, 无需另配轴环, 热套。
- 标准化固定端轴端形状和尺寸, 可直接装配KSS支撑单元。
- 支撑端未加工, 可按客户规格要求自由调节长度。
- 可按实际要求对应标准以外的轴端形状。
- 全螺纹未加工型具有优越的性价比, 可按客户要求追加加工轴端。
- 轴向间隙设定为5um以下, 也可按客户要求提供无轴向间隙的产品。

#### ●种类

精密轧制滚珠丝杠有轴端比丝杠轴粗的台阶型 (PSRT) 和全螺纹未加工型2种 (PSR)

#### 【台阶型/ Integrated journal type】

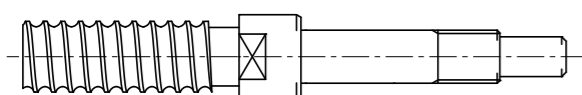

High accuracy (JIS C5) has been achieved by Rolled Ball Screw. We provide Rolled Ball Screws with high precision & better cost performance, which can be replaced with conventional Ground Ball Screw with C5 grade.

#### ●Features

- The conventional type of Rolled Ball Screws can reach the Accuracy grade of Ct10 or Ct7. KSS newly developed the high grade accuracy of Rolled Ball Screw, which can achieve JIS C5 grade.
- We have 2 types of Precision Rolled Ball Screws, which are Integrated type with larger journal and whole threaded type. So it provides wide variety of design choices.
- For Integrated end-journal type, Fixed side end-journal can be set larger than nominal diameter of Screw Shaft, so there is no need to use Collar by press fit.
- Fixed side End-journal profile and dimension are standardized, so KSS Compact Support-Unit can be installed.
- Since supported-side end-journal is unfinished, it is possible to do additional end machining with your requested thread length.
- Special end-journal profile can be available as customized order.
- Whole threaded type is a high cost performance type and end-journal machining is available in accordance with your request.
- The Axial play is set at 5um or less, but Zero backlash is possible based on your request.

#### ●Variation

We have 2 types of Precision Rolled Ball Screws, which are Integrated type with larger journal (PSRT) and whole threaded length type (PSR).

#### 【全螺纹未加工型/ whole threaded type】

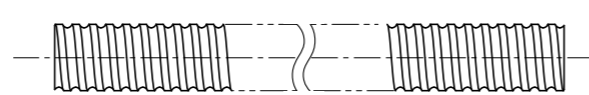

#### ●丝杠轴公称外径和导程组合 Combination of Shaft nominal dia. & Lead

Unit (单位): mm

Lead 导程	1		2	12
4	A323 A324	A325 A326		
6	A327 A328	A329 A330		
8	A331 A332	A333 A334	A335 A336	A337 A338
10			A341 A342	
12			A343 A344	

注1) 表中数字: 刊载页码

Note 1) The numbers in a table : showing a page in this catalogue

#### ●精度等级和轴向间隙

PSR/PSRT 系列 (精密冷轧滚珠丝杠标准库存品) 的精度等级为, C5 (JIS B-1192)。  
轴向间隙为0.005mm以下, 可按实际要求提供无轴向间隙 (预压) 的产品。

#### ●材质和表面硬度

PSR/PSRT 系列 (精密冷轧滚珠丝杠标准库存品) 的材质和表面硬度如下。

Products 产品种类	Material of thread area 滚珠丝杠部材质	Heat treatment 热处理	Surface hardness 滚珠丝杠部表面硬度
Precision Rolled Ball Screws (PSR series) 精密冷轧滚珠丝杠 (PSR系列)	Shaft / 丝杠轴: S55C	Induction hardening 高频热处理	HRC58 or more HRC58以上
	Nut / 螺母: SCM415	Carburizing and Quenching 渗碳热处理	
Precision Rolled Ball Screws with Integrated end-journal (PSRT series) 台阶性精密冷轧滚珠丝杠 (PSRT系列)	Shaft / 丝杠轴: S55C	Induction hardening 高频热处理	HRC58 or more HRC58以上
	Nut / 螺母: SCM415	Carburizing and Quenching 渗碳热处理	

#### ●润滑

精密冷轧滚珠丝杠全螺纹未加工型 (PSR系列) 库存用防锈油做好了防锈处理。防锈油无润滑作用, 使用时请另行涂布润滑脂。无特别指示, 将推荐KSS特制润滑脂 (MSG No.2)

#### ●其他

PSR/PSRT 系列 (精密冷轧滚珠丝杠标准库存品), 除了标准螺母 (回路板式以及端盖式) 以外, 还备有紧凑型螺母 (陀螺式)。可按实际用途选用。

#### ●Accuracy Grade & Axial play

The grade of PSR/PSRT series (Standardized Precision Rolled Ball Screws) is C5 (JIS B-1192). Axial play of this series is 0.005mm or less, but zero backlash (pre-load) type is available by your request.

#### ●Material & Surface hardness

The material and hardness of PSR/PSRT series (Standardized Precision Rolled Ball Screws) are as follows.

#### ●Lubrication

Standardized Precision Rolled Ball Screws whole threaded length type (PSR Series) will be supplied with anti-rust oil. This oil is not lubricant, when Ball Screw operates, lubricant should be applied. If there is no specific instruction, KSS would recommend our original grease (MSG No.2) as standard lubricant. Please feel free to contact us.

#### ●Others

PSR/PSRT series (Standardized Precision Rolled Ball Screws) provide 3 types of Ball Nut profile. Return-plate style and End-cap style are our standard. In addition Internal-Deflector style as Compact Ball Nut is also in stock. So you can pick one of them based on your design.

## ● 公称型号的构成 Model number notation

### 【台阶型/ Integrated journal type】

如需台阶型追加工, 请按以下公称型号指示长度, 轴端形状, 螺母方向 (红字部分)。

In case of PSRT type (Integrated journal type), please designate length, end-journal profile, lubricant and Nut direction (in red ink below) according to the Model number notation below.

PSRT 08 01 K — 155 R 204 C5 B 0 X

1 2 3 4 5 6 7 8 9 10 11

#### 1精密冷轧滚珠丝杠记号

PSRT : 台阶型

#### 2丝杠轴工程外径 (mm)

#### 3导程 (mm)

#### 4螺母形式

无记号 : 一般

K : 紧凑型

#### 5螺纹部长度 (mm)

(追加工后按1mm单位指定)

#### 6螺纹方向 (R=右旋)

#### 7丝杠轴总长 (mm)

(按1mm单位指定)

#### 8精度等级 (JIS C5级)

#### 9轴端加工型

参照图 A-26 : A-type, B-type, C-type, D-type (其他)

#### ⑩涂布

0 : KSS推荐润滑脂 (MSG No.2)

1 : 防锈油 (Non Ruster PZ2)

2 : Multemp PS2

3 : 其他

#### ⑪螺母法兰方向 (参照图 A-27)

#### 1Precision Rolled Ball Screws Series No.

PSRT : Integrated journal type

#### 2Screw Shaft nominal diameter (mm)

#### 3Lead (mm)

#### 4Ball Nut type

None : Standard

K : Compact type

#### 5Screw thread length (mm)

(Specify in 1mm unit after end-journal machining)

#### 6Thread direction (R=Right-hand)

#### 7Screw Shaft total length (mm)

(Specify in 1mm unit)

#### 8Accuracy grade (JIS C5)

#### 9Shaft end-journal profile

Refer to Fig. A-26 below : A-type, B-type, C-type, D-type (Othes)

#### ⑩Anti-rust oil or Lubricant

0 : KSS grease (MSG No.2)

1 : Anti-rust oil (Non Ruster PZ2)

2 : Multemp PS2 grease

3 : Other

#### ⑪Nut Flange direction (Refer to Fig. A-27 below)

### 【全螺纹未加工型/ Whole threaded type】

全螺纹未加工的公称型号的构成如下。

轴端追加工, 请提供图纸。

Model number notation of PSR type (whole threaded type) is as follows. Please designate end-journal profile with your simple sketch.

PSR 08 01 K — 230 R 230 C5

1 2 3 4 5 6 7 8

#### 1精密冷轧滚珠丝杠记号

PSR : 全螺纹未加工型

#### 2丝杠轴工程外径 (mm)

#### 3导程 (mm)

#### 4螺母形式

无记号 : 一般

K : 紧凑型

#### 5螺纹部长度 (mm)

(追加工后按1mm单位指定)

#### 6螺纹方向 (R=右旋)

#### 7丝杠轴总长 (mm)

(按1mm单位指定)

#### 8精度等级 (JIS C5级)

#### 1Precision Rolled Ball Screws Series No.

PSR : Whole threaded type

#### 2Screw Shaft nominal diameter (mm)

#### 3Lead (mm)

#### 4Ball Nut type

None : Standard

K : Compact type

#### 5Screw thread length (mm)

(Specify in 1mm unit after end-journal machining)

#### 6Thread direction (R=Right-hand)

#### 7Screw Shaft total length (mm)

(Specify in 1mm unit)

#### 8Accuracy grade (Class JIS C5)

### ● 特殊规格品

可接单生产以下内容的特殊设计, 请垂询KSS。

- 1) 不同于标准的轴端形状, 尺寸。
- 2) 不同于标准的螺母形状, 尺寸。
- 3) 轴向间隙为零 (预压规格) 的产品。
- 4) 大于标准长度的产品。

### ● Customized Design

It will be the customized if you need special specifications like below, please ask KSS representative.

- 1) Non-standard profile or dimension on Shaft end-journal.
- 2) Non-standard profile or dimension on Ball Nut or Flange.
- 3) Zero backlash (Pre - loaded) type Ball Screw.
- 4) Longer length of Ball Screw Shaft than standard product.

### ● 备注

- 1) 按要求可提供无轴向间隙 (预压) 的产品, 请垂询KSS。
- 2) 推荐KSS进行轴端追加工。
- 3) 追加工时请提供追加工指示图 (简易图)。
- 4) 不予受理螺母追加工, 请按法兰形状等标准形状进行设计。
- 5) 滚珠丝杠必须涂布润滑脂使用。请注意防锈油无润滑作用。

### ● Note

- 1) Zero backlash is possible by your request, please ask KSS representative.
- 2) We recommend additional end-journal machining is done by KSS. We do not guarantee accuracy after re-works done by other than KSS.
- 3) Please send us drawing with end-journal profile when you request end-journal machining.
- 4) Additional machining is not applied to the Nut. Please design flange configuration according to our standard dimension.
- 5) In Ball Screws use, lubricant should be applied on them. Please note that anti-rust oil is not lubricant.

图 A-26 : 轴端加工型  
Fig. A-26 : Shaft end-journal profile

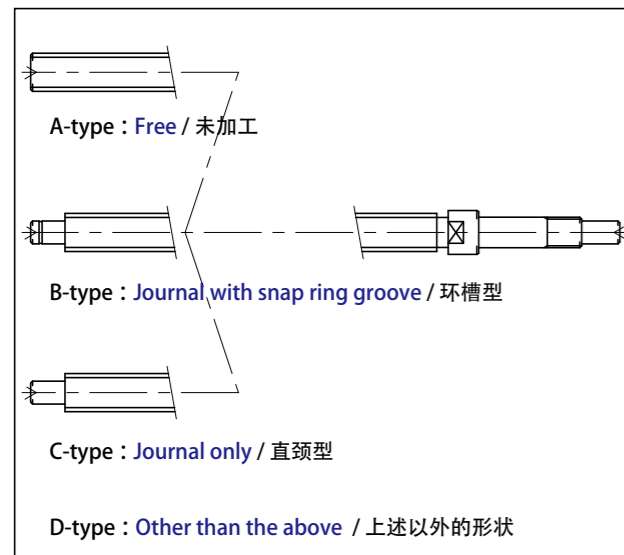

### ● 备注

- 1) 轴端详细尺寸请参照各页内容。
- 2) KSS不受理螺母的追加工。
- 3) 规格如有更改恕不另行通知。
- 4) 如需标准轴端 (A,B,C) 以外的形状, 请垂询KSS。
- 5) 客户自行追加工不予品质保证。

图 A-27 : 螺母法兰方向  
Fig. A-27 : Nut Flange direction

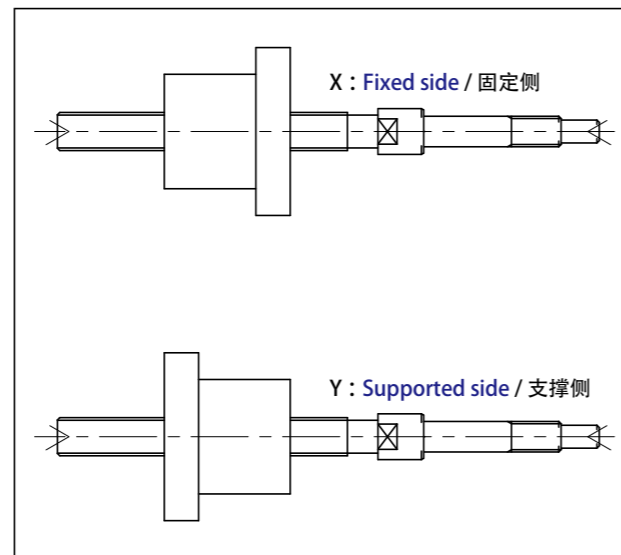

### ● Note

- 1) The detail of end-journal dimension for each size is shown from next page.
- 2) KSS does not make additional Nut machining.
- 3) The specification is subject to change without notice.
- 4) If the other configuration except (A,B,C) is requested, please contact KSS.
- 5) KSS will not be responsible for quality, in case re-work is done by other than KSS.

Standard products in stock PSR series  
标准库存品 PSR系列

PSR0401

Shaft dia. (轴径)  $\phi 4$  Lead (导程) 1mm

C5

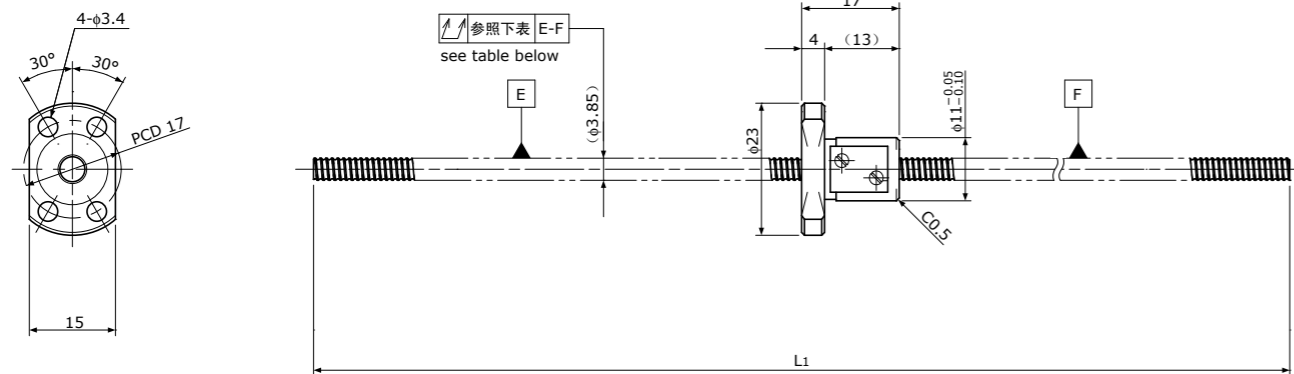

Unit (单位) : mm

Ball Screw Specifications		规格
Ball size 钢珠直径		$\phi 0.8$
Number of thread 螺纹条数		1
Thread direction 螺纹方向		Right 右
Shaft root dia. 丝杠轴低径		$\phi 3.3$
Number of circuit 循环数		$3.7 \times 1$
Material 材质	Shaft 轴	S55C
	Nut 螺母	SCM415H
Surface hardness 螺纹部表面硬度		HRC58~ (Thread area)
Anti-rust treatment 防锈处理		Anti-rust oil 防锈油

Unit (单位) : mm

Ball Screw Model 滚珠丝杠型号	Travel 行程	Shaft length 丝杠轴长度		Travel deviation 代表移动量误差 $e_p$	Total Run-out 全跳动 $\uparrow$	Axial play 轴向间隙	Basic Load Rating 基本额定负载 N	
		$L_1$	$L_2$				Dynamic 额定动负载 $C_a$	Static 额定静负载 $C_{0a}$
PSR0401-100R100C5	75	100		$\pm 0.018$	0.035	$\sim 0.005$	560	790

Note) Please designate end-journal profile with your sketch. 注) 轴端追加工请提供图纸。

Standard products in stock PSRT series  
标准库存品 PSRT系列

PSRT0401

Shaft dia. (轴径)  $\phi 4$  Lead (导程) 1mm

C5

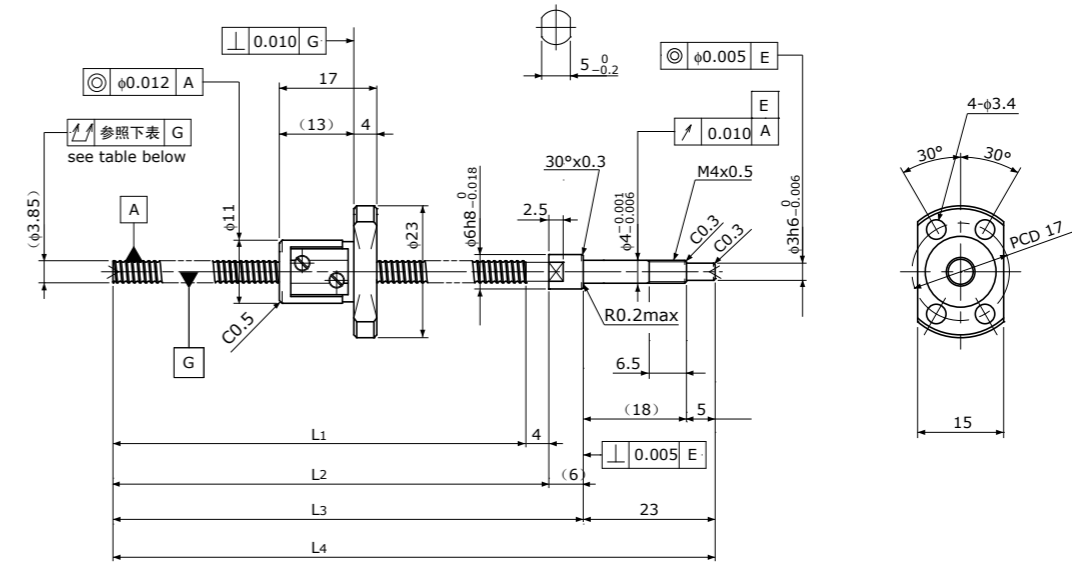

Unit (单位) : mm

Ball Screw Specifications		规格
Ball size 钢珠直径		$\phi 0.8$
Number of thread 螺纹条数		1
Thread direction 螺纹方向		Right 右
Shaft root dia. 丝杠轴低径		$\phi 3.3$
Number of circuit 循环数		$3.7 \times 1$
Material 材质	Shaft 轴	S55C+SUS303
	Nut 螺母	SCM415H
Surface hardness 螺纹部表面硬度		HRC58~ (Thread area)
Lubrication 润滑剂		KSS Original Grease MSG No.2

Supported-side end-journal profile 支撑侧轴端加工形状

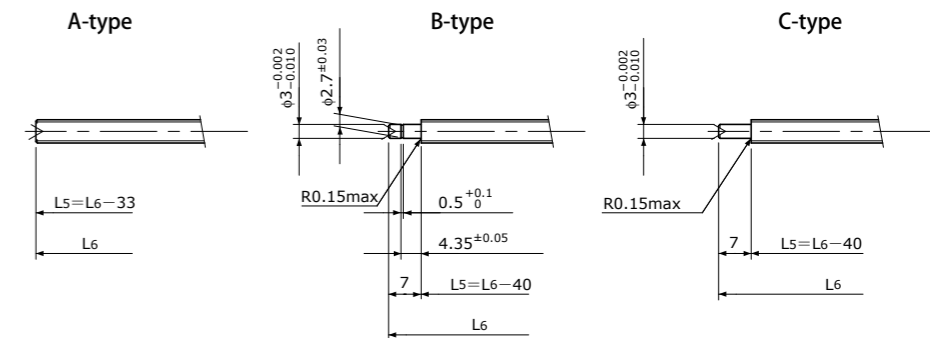
L5: Thread length after end-journal machining. 追加工后的螺纹部长度  
L6: Total length after end-journal machining. 追加工后的总长Support-unit Recommendation 推荐的支撑单元  
Supported-side 支撑侧 : MSU-4CS/4GS, SUP03-S  
Fixed-side 固定侧 : MSU-4C/4G, EK4

D-type : Other than the above. 上述以外的形状

Unit (单位) : mm

Ball Screw Model 滚珠丝杠型号	Travel 行程	Shaft length 丝杠轴长度				Travel deviation 代表移动量误差 $e_p$	Total Run-out 全跳动 $\uparrow$	Axial play 轴向间隙	Basic Load Rating 基本额定负载 N	
		$L_1$	$L_2$	$L_3$	$L_4$				Dynamic 额定动负载 $C_a$	Static 额定静负载 $C_{0a}$
PSRT0401-72R105C5	50	72	76	82	105	$\pm 0.018$	0.035	$\sim 0.005$	560	790

Note) Please refer to page A-321 for order code of end-journal machining. 注) 追加工的公称型号指定方法, 请参照A-321页



Standard products in stock PSR series  
标准库存品 PSR系列

PSR0601

Shaft dia. (轴径)  $\phi 6$  Lead (导程) 1mm

C5

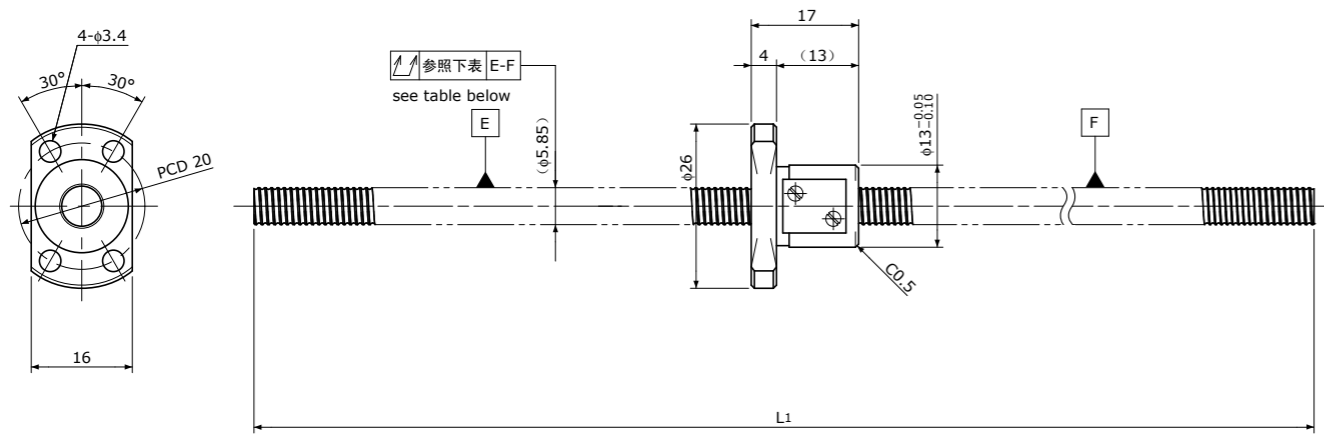

Unit (单位) : mm

Ball Screw Specifications 规格	
Ball size 钢珠直径	$\phi 0.8$
Number of thread 螺纹条数	1
Thread direction 螺纹方向	Right 右
Shaft root dia. 丝杠轴低径	$\phi 5.3$
Number of circuit 循环数	$3.7 \times 1$
Material 材质	Shaft 轴 S55C Nut 螺母 SCM415H
Surface hardness 螺纹部表面硬度	HRC58~ (Thread area)
Anti-rust treatment 防锈处理	Anti-rust oil 防锈油

Unit (单位) : mm

Ball Screw Model 滚珠丝杠型号	Travel 行程	Shaft length 丝杠轴长度 $L_1$	Travel deviation 代表移动量误差 $e_p$	Total Run-out 全跳动 $\uparrow$	Axial play 轴向间隙 $\sim 0.005$	Basic Load Rating 基本额定负载 N	
						Dynamic 额定动负载 $C_a$	Static 额定静负载 $C_{0a}$
PSR0601-200R200C5	175	200	$\pm 0.020$	0.050	$\sim 0.005$	680	1200

Note) Please designate end-journal profile with your sketch. 注) 轴端追加工请提供图纸。

Standard products in stock PSRT series  
标准库存品 PSRT系列

PSRT0601

Shaft dia. (轴径)  $\phi 6$  Lead (导程) 1mm

C5

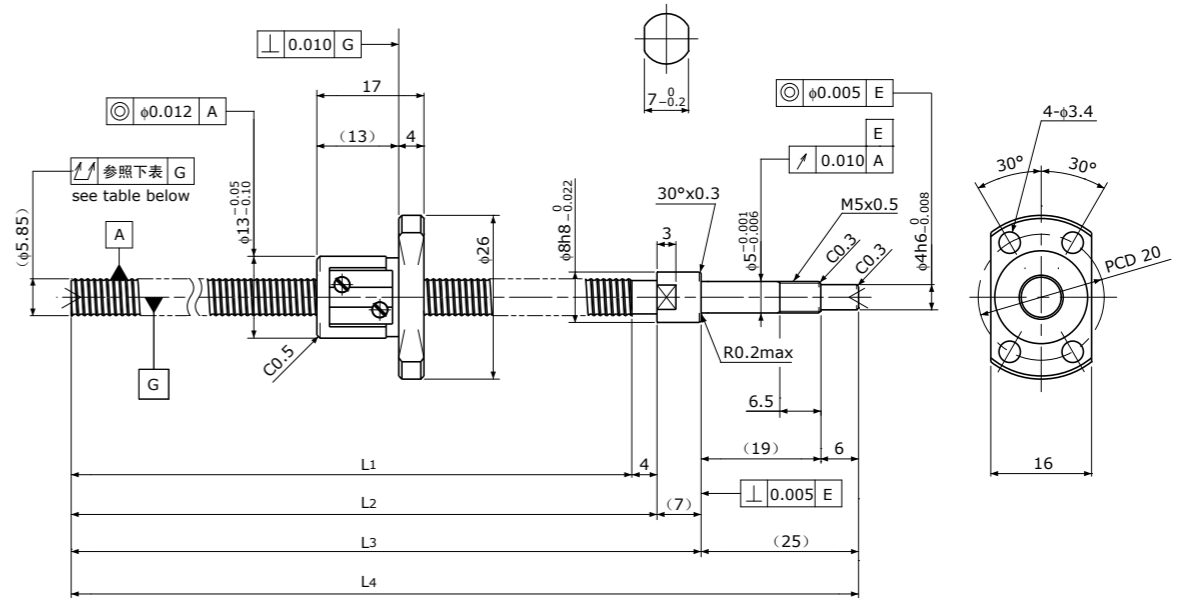

Unit (单位) : mm

Ball Screw Specifications 规格	
Ball size 钢珠直径	$\phi 0.8$
Number of thread 螺纹条数	1
Thread direction 螺纹方向	Right 右
Shaft root dia. 丝杠轴低径	$\phi 5.3$
Number of circuit 循环数	$3.7 \times 1$
Material 材质	Shaft 轴 S55C+SUS303 Nut 螺母 SCM415H
Surface hardness 螺纹部表面硬度	HRC58~ (Thread area)
Lubrication 润滑剂	KSS Original Grease MSG No.2

Supported-side end-journal profile 支撑侧轴端加工形状

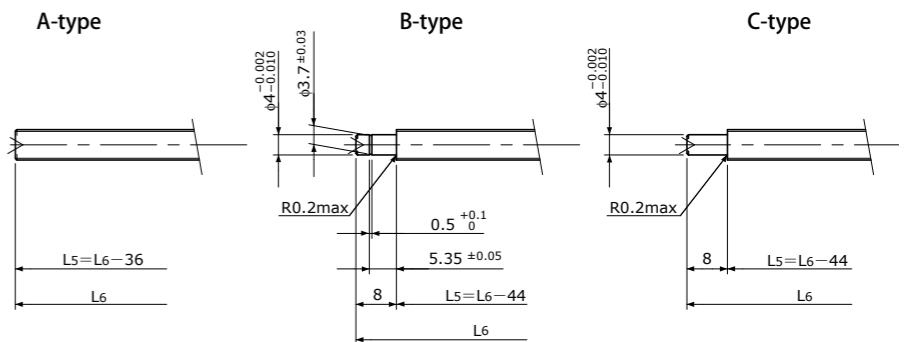
L5: Thread length after end-journal machining. 追加工后的螺纹部长度  
L6: Total length after end-journal machining. 追加工后的总长Support-unit Recommendation 推荐的支撑单元  
Supported-side 支撑侧 : MSU-5CS/5GS, SUP04-S  
Fixed-side 固定侧 : MSU-5C/5G, EK5

D-type: Other than the above. 上述以外的形状

Unit (单位) : mm

Ball Screw Model 滚珠丝杠型号	Travel 行程	Shaft length 丝杠轴长度				Travel deviation 代表移动量误差 $e_p$	Total Run-out 全跳动 $\uparrow$	Axial play 轴向间隙 $\sim 0.005$	Basic Load Rating 基本额定负载 N	
		L1	L2	L3	L4				Dynamic 额定动负载 $C_a$	Static 额定静负载 $C_{0a}$
PSRT0601-89R125C5	65	89	93	100	125	$\pm 0.018$	0.035	$\sim 0.005$	680	1200

Note) Please refer to page A-321 for order code of end-journal machining. 注) 追加工的公称型号指定方法, 请参照A-321页

Standard products in stock PSR series  
标准库存品 PSR系列

PSR0601K

Compact Nut / 紧凑型螺母  
Shaft dia. (轴径)  $\phi 6$  Lead (导程) 1mm

C5

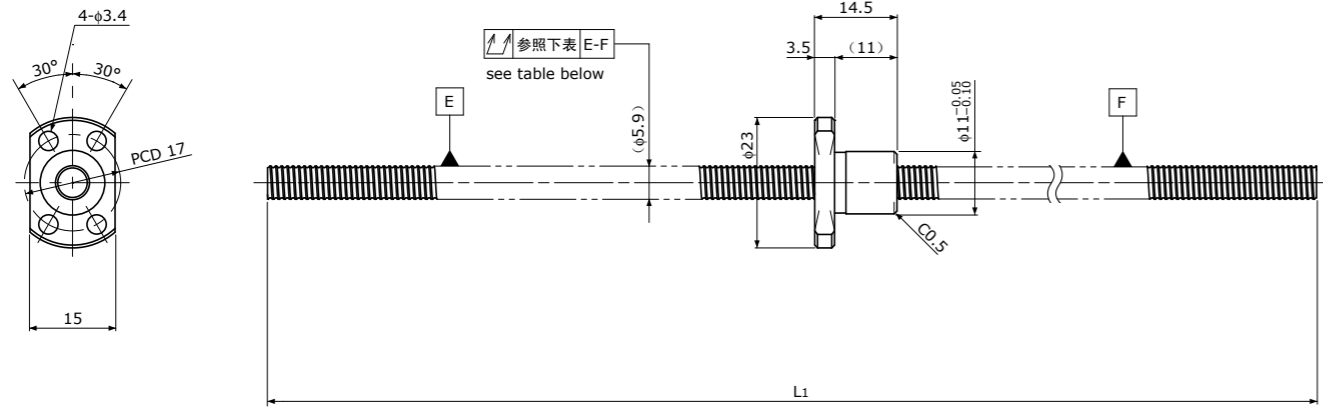

Unit (单位) : mm

Ball Screw Specifications		规格
Ball size 钢珠直径		$\phi 0.8$
Number of thread 螺纹条数		1
Thread direction 螺纹方向		Right 右
Shaft root dia. 丝杠轴低径		$\phi 5.3$
Number of circuit 循环数		1×3
Material 材质	Shaft 轴	S55C
	Nut 螺母	SCM415H
Surface hardness 螺纹部表面硬度		HRC58~ (Thread area)
Anti-rust treatment 防锈处理		Anti-rust oil 防锈油

Unit (单位) : mm

Ball Screw Model 滚珠丝杠型号	Travel 行程	Shaft length 丝杠轴长度	Travel deviation 代表移动量误差 $e_p$	Total Run-out 全跳动 $\uparrow$	Axial play 轴向间隙	Basic Load Rating 基本额定负载 N	
		$L_1$				Dynamic 额定动负载 $C_a$	Static 额定静负载 $C_oa$
PSR0601K-200R2000C5	180	200	$\pm 0.020$	0.050	$\sim 0.005$	560	950

Note) Please designate end-journal profile with your sketch. 注) 轴端追加工请提供图纸。

Standard products in stock PSRT series  
标准库存品 PSRT系列

PSRT0601K

Compact Nut / 紧凑型螺母  
Shaft dia. (轴径)  $\phi 6$  Lead (导程) 1mm

C5

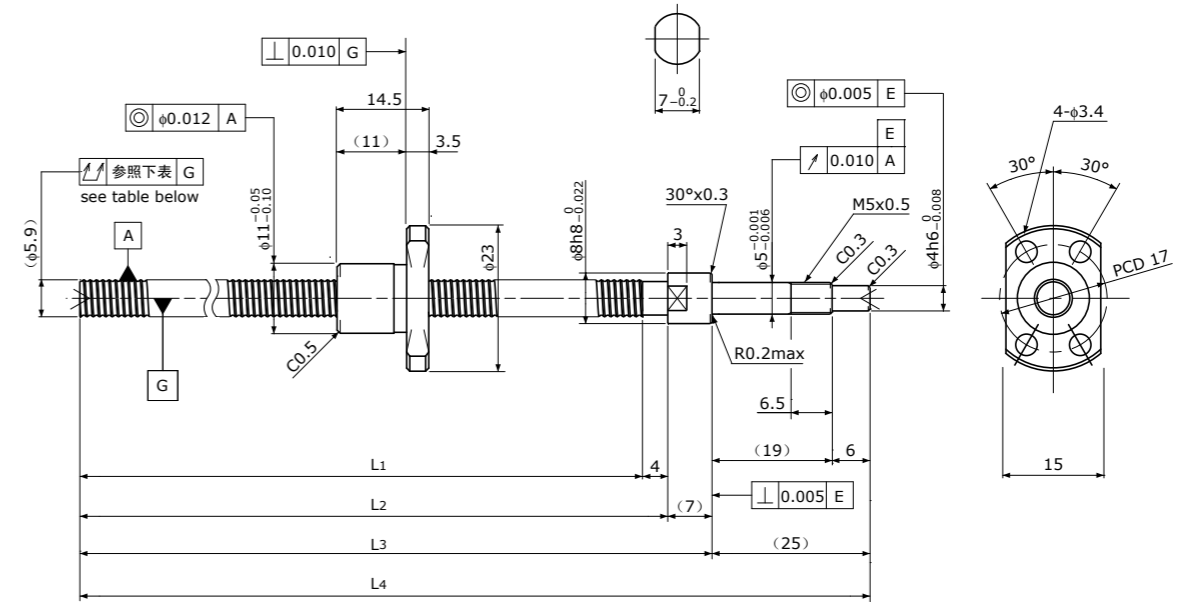

Unit (单位) : mm

Ball Screw Specifications		规格
Ball size 钢珠直径		$\phi 0.8$
Number of thread 螺纹条数		1
Thread direction 螺纹方向		Right 右
Shaft root dia. 丝杠轴低径		$\phi 5.3$
Number of circuit 循环数		1×3
Material 材质	Shaft 轴	S55C + SUS303
	Nut 螺母	SCM415H
Surface hardness 螺纹部表面硬度		HRC58~ (Thread area)
Lubrication 润滑剂		KSS Original Grease MSG No.2

Supported-side end-journal profile 支撑侧轴端加工形状

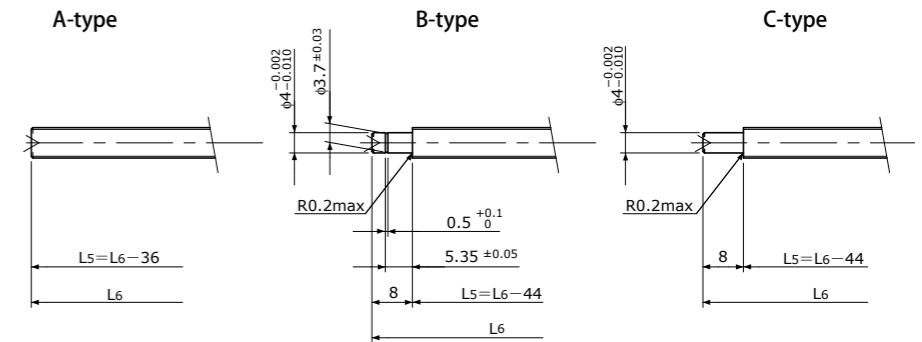

$L_5$ : Thread length after end-journal machining. 追加工后的螺纹部长度  
 $L_6$ : Total length after end-journal machining. 追加工后的总长

Support-unit Recommendation 推荐的支撑单元	Supported-side 支撑侧	Fixed-side 固定侧
	MSU-5CS/5GS, SUP04-S	MSU-5C/5G, EK5

D-type: Other than the above. 上述以外的形状

Unit (单位) : mm

Ball Screw Model 滚珠丝杠型号	Travel 行程	Shaft length 丝杠轴长度				Travel deviation 代表移动量误差 $e_p$	Total Run-out 全跳动 $\uparrow$	Axial play 轴向间隙	Basic Load Rating 基本额定负载 N	
		$L_1$	$L_2$	$L_3$	$L_4$				Dynamic 额定动负载 $C_a$	Static 额定静负载 $C_oa$
PSRT0601K-89R125C5	65	89	93	100	125	$\pm 0.018$	0.035	$\sim 0.005$	560	950

Note) Please refer to page A-321 for order code of end-journal machining. 注) 追加工的公称型号指定方法, 请参照A-321页

Standard products in stock PSR series  
标准库存品 PSR系列

PSR0801

Shaft dia. (轴径)  $\phi 8$  Lead (导程) 1mm

C5

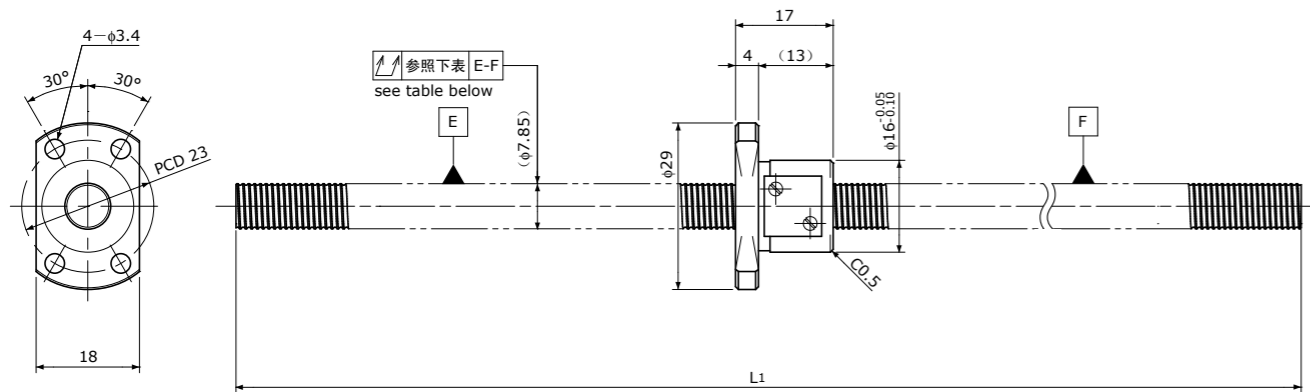

Unit (单位) : mm

Ball Screw Specifications		规格
Ball size 钢珠直径		$\phi 0.8$
Number of thread 螺纹条数		1
Thread direction 螺纹方向		Right 右
Shaft root dia. 丝杠轴低径		$\phi 7.3$
Number of circuit 循环数		$3.7 \times 1$
Material 材质	Shaft 轴	S55C
	Nut 螺母	SCM415H
Surface hardness 螺纹部表面硬度		HRC58~ (Thread area)
Anti-rust treatment 防锈处理		Anti-rust oil 防锈油

Unit (单位) : mm

Ball Screw Model 滚珠丝杠型号	Travel 行程	Shaft length 丝杠轴长度		Travel deviation 代表移动量误差 $e_p$	Total Run-out 全跳动 $\uparrow$	Axial play 轴向间隙	Basic Load Rating 基本额定负载 N	
		$L_1$					Dynamic 额定动负载 $C_a$	Static 额定静负载 $C_{0a}$
PSR0801-230R230C5	205	230		$\pm 0.023$	0.065	$\sim 0.005$	780	1650

Note) Please designate end-journal profile with your sketch. 注) 轴端追加工请提供图纸。

Standard products in stock PSRT series  
标准库存品 PSRT系列

PSRT0801

Shaft dia. (轴径)  $\phi 8$  Lead (导程) 1mm

C5

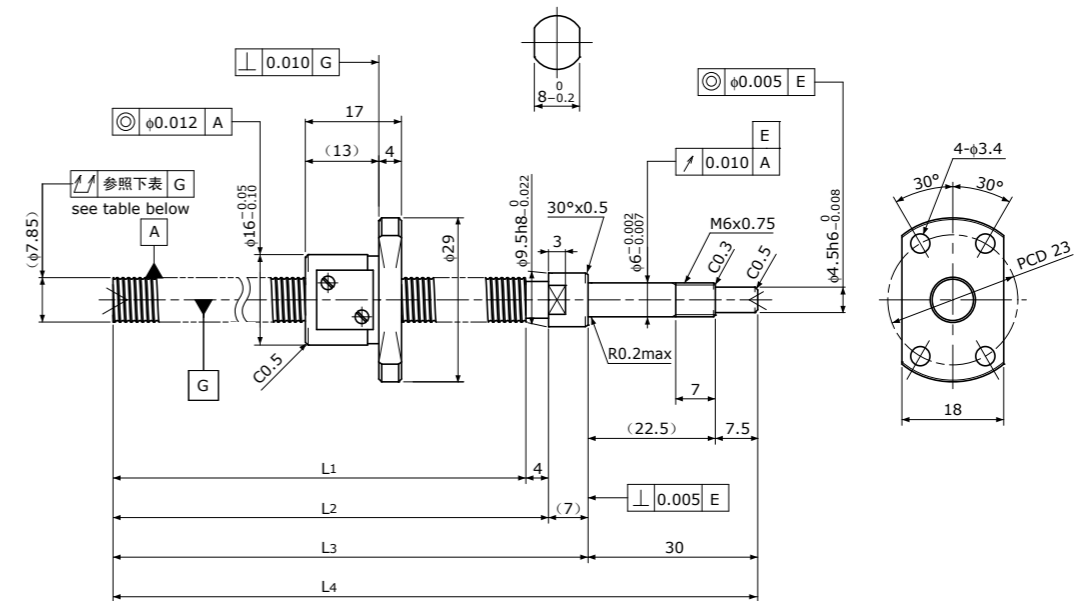

Unit (单位) : mm

Ball Screw Specifications		规格
Ball size 钢珠直径		$\phi 0.8$
Number of thread 螺纹条数		1
Thread direction 螺纹方向		Right 右
Shaft root dia. 丝杠轴低径		$\phi 7.3$
Number of circuit 循环数		$3.7 \times 1$
Material 材质	Shaft 轴	S55C + SUS303
	Nut 螺母	SCM415H
Surface hardness 螺纹部表面硬度		HRC58~ (Thread area)
Lubrication 润滑剂		KSS Original Grease MSG No.2

Supported-side end-journal profile 支撑侧轴端加工形状

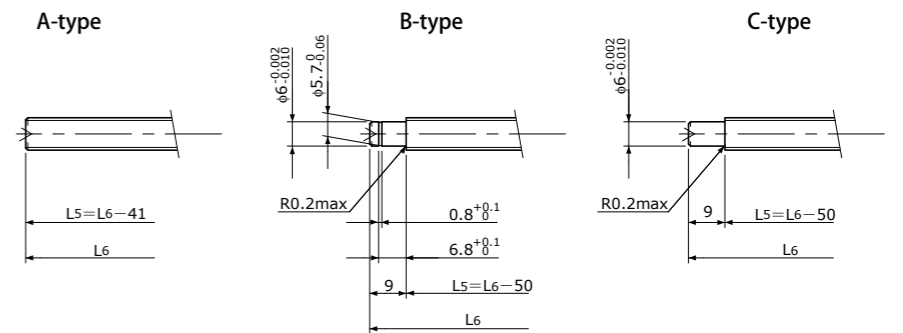
L5: Thread length after end-journal machining. 追加工后的螺纹部长度  
L6: Total length after end-journal machining. 追加工后的总长

Support-unit Recommendation 推荐的支撑单元	Supported-side 支撑侧	
	MSU-6CS/6GS, EF6	Fixed-side 固定侧

D-type: Other than the above. 上述以外的形状

Unit (单位) : mm

Ball Screw Model 滚珠丝杠型号	Travel 行程	Shaft length 丝杠轴长度				Travel deviation 代表移动量误差 $e_p$	Total Run-out 全跳动 $\uparrow$	Axial play 轴向间隙	Basic Load Rating 基本额定负载 N	
		$L_1$	$L_2$	$L_3$	$L_4$				Dynamic 额定动负载 $C_a$	Static 额定静负载 $C_{0a}$
PSRT0801-169R210C5	145	169	173	180	210	$\pm 0.020$	0.065	$\sim 0.005$	780	1650

Note) Please refer to page A-321 for order code of end-journal machining. 注) 追加工的公称型号指定方法, 请参照A-321页

Standard products in stock PSR series  
标准库存品 PSR系列

PSR0801K

Compact Nut / 紧凑型螺母  
Shaft dia. (轴径)  $\phi 8$  Lead (导程) 1mm

C5

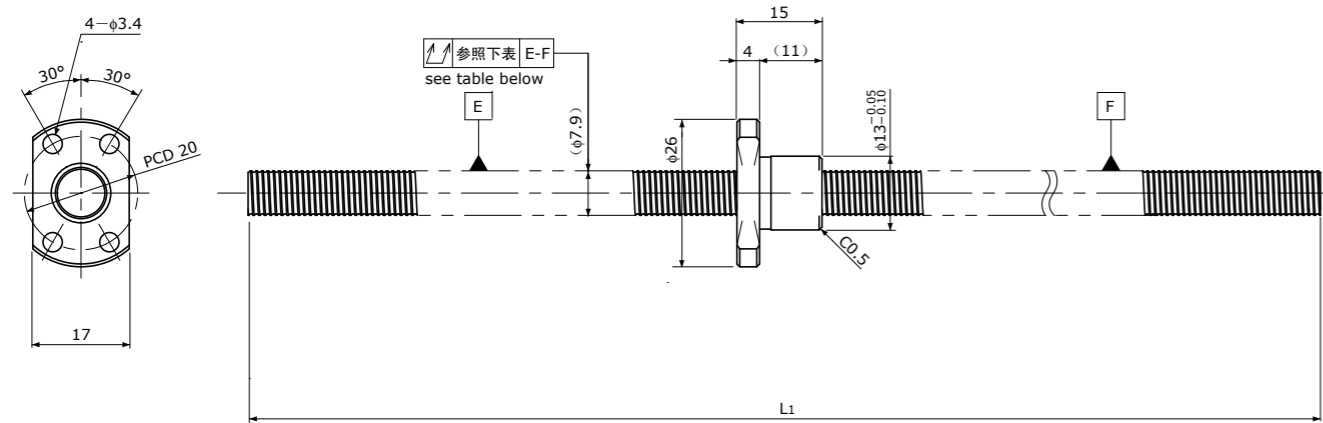

Unit (单位) : mm

Ball Screw Specifications		规格
Ball size 钢球直径		$\phi 0.8$
Number of thread 螺纹条数		1
Thread direction 螺纹方向		Right 右
Shaft root dia. 丝杠轴低径		$\phi 7.3$
Number of circuit 循环数		1×3
Material 材质	Shaft 轴	S55C
	Nut 螺母	SCM415H
Surface hardness 螺纹部表面硬度		HRC58~ (Thread area)
Anti-rust treatment 防锈处理		Anti-rust oil 防锈油

Unit (单位) : mm

Ball Screw Model 滚珠丝杠型号	Travel 行程	Shaft length 丝杠轴长度		Travel deviation 代表移动量误差 $e_p$	Total Run-out 全跳动 $\uparrow$	Axial play 轴向间隙	Basic Load Rating 基本额定负载 N	
		$L_1$	$L_2$				Dynamic 额定动负载 $C_a$	Static 额定静负载 $C_{0a}$
PSR0801K-230R230C5	210	230		$\pm 0.023$	0.065	$\sim 0.005$	650	1300

Note) Please designate end-journal profile with your sketch. 注) 轴端追加工请提供图纸。

Standard products in stock PSRT series  
标准库存品 PSRT系列

PSRT0801K

Compact Nut / 紧凑型螺母  
Shaft dia. (轴径)  $\phi 8$  Lead (导程) 1mm

C5

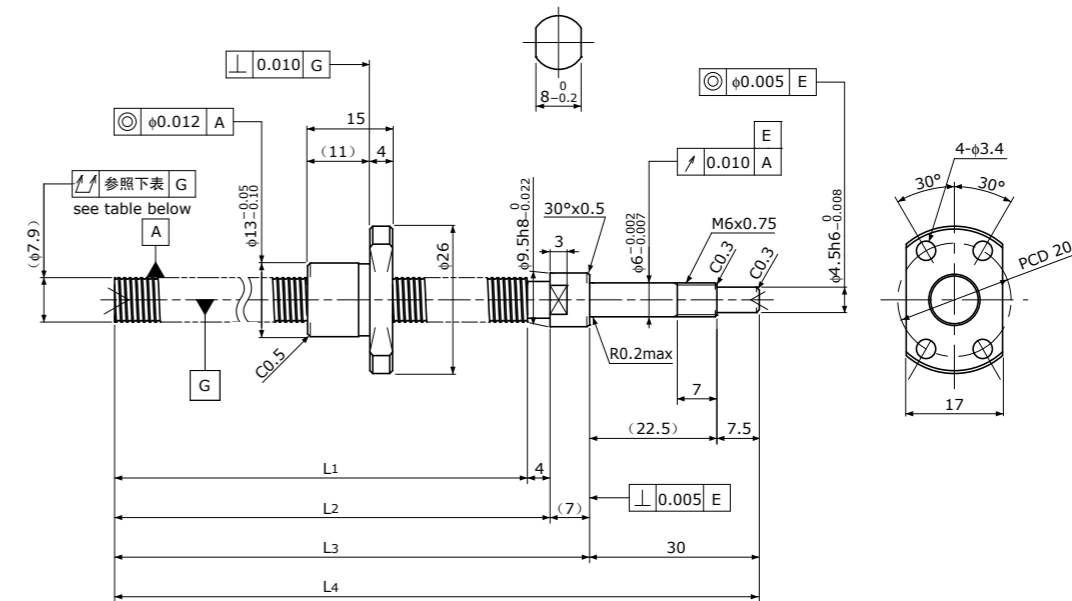

Unit (单位) : mm

Ball Screw Specifications		规格
Ball size 钢球直径		$\phi 0.8$
Number of thread 螺纹条数		1
Thread direction 螺纹方向		Right 右
Shaft root dia. 丝杠轴低径		$\phi 7.3$
Number of circuit 循环数		1×3
Material 材质	Shaft 轴	S55C + SUS303
	Nut 螺母	SCM415H
Surface hardness 螺纹部表面硬度		HRC58~ (Thread area)
Lubrication 润滑剂		KSS Original Grease MSG No.2

Supported-side end-journal profile 支撑侧轴端加工形状

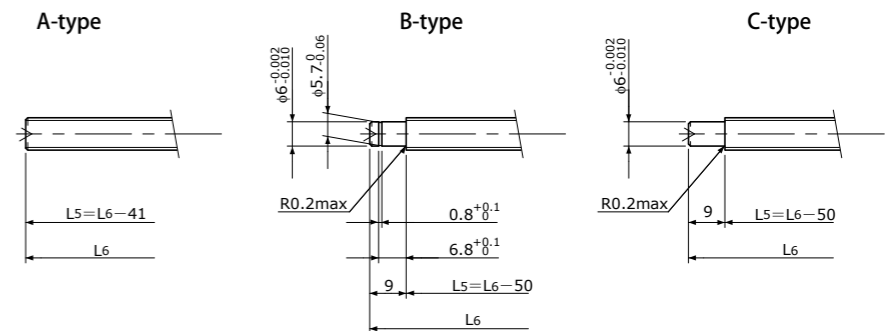
L5: Thread length after end-journal machining. 追加工后的螺纹部长度  
L6: Total length after end-journal machining. 追加工后的总长

Support-unit Recommendation 推荐的支撑单元	Supported-side 支撑侧	
	Fixed-side 固定侧	MSU-6CS/6GS, EF6

D-type: Other than the above. 上述以外的形状

Unit (单位) : mm

Ball Screw Model 滚珠丝杠型号	Travel 行程	Shaft length 丝杠轴长度				Travel deviation 代表移动量误差 $e_p$	Total Run-out 全跳动 $\uparrow$	Axial play 轴向间隙	Basic Load Rating 基本额定负载 N	
		$L_1$	$L_2$	$L_3$	$L_4$				Dynamic 额定动负载 $C_a$	Static 额定静负载 $C_{0a}$
PSRT0801K-169R210C5	145	169	173	180	210	$\pm 0.020$	0.065	$\sim 0.005$	650	1300

Note) Please refer to page A-321 for order code of end-journal machining. 注) 追加工的公称型号指定方法, 请参照A-321页



Standard products in stock PSR series  
标准库存品 PSR系列

PSR0802

Shaft dia. (轴径)  $\phi 8$  Lead (导程) 2mm

C5

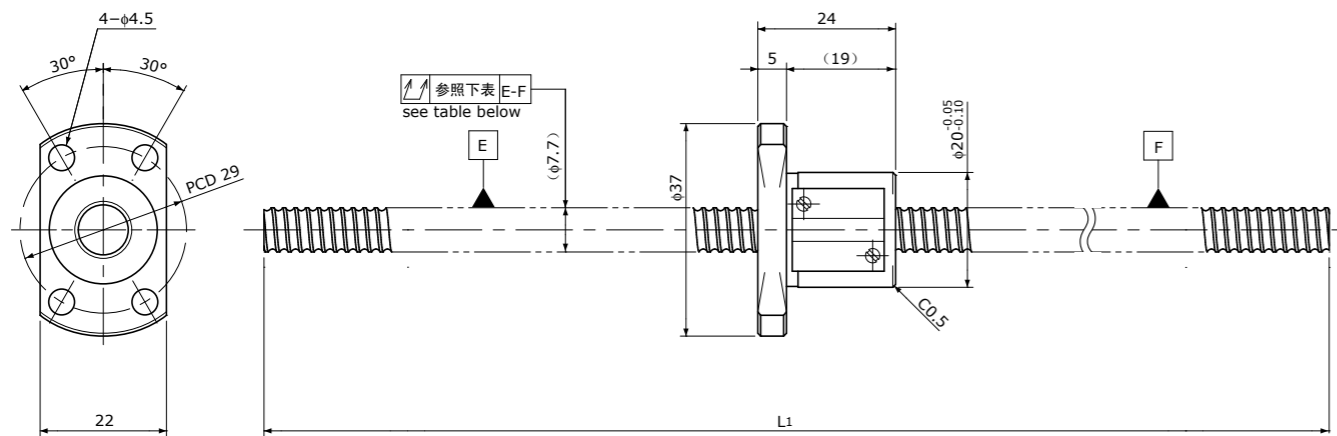

Unit (单位) : mm

Ball Screw Specifications 规格		
Ball size 钢珠直径		$\phi 1.5875$
Number of thread 螺纹条数		1
Thread direction 螺纹方向		Right 右
Shaft root dia. 丝杠轴低径		$\phi 6.6$
Number of circuit 循环数		$3.7 \times 1$
Material 材质	Shaft 轴	S55C
	Nut 螺母	SCM415H
Surface hardness 螺纹部表面硬度		HRC58~ (Thread area)
Anti-rust treatment 防锈处理		Anti-rust oil 防锈油

Unit (单位) : mm

Ball Screw Model 滚珠丝杠型号	Travel 行程	Shaft length 丝杠轴长度		Travel deviation 代表移动量误差 $e_p$	Total Run-out 全跳动 $\uparrow$	Axial play 轴向间隙	Basic Load Rating 基本额定负载 N	
		$L_1$					Dynamic 额定动负载 $C_a$	Static 额定静负载 $C_{0a}$
PSR0802-230R230C5	200	230		$\pm 0.023$	0.065	$\sim 0.005$	2400	4100

Note) Please designate end-journal profile with your sketch. 注) 轴端追加工请提供图纸。

Standard products in stock PSRT series  
标准库存品 PSRT系列

PSRT0802

Shaft dia. (轴径)  $\phi 8$  Lead (导程) 2mm

C5

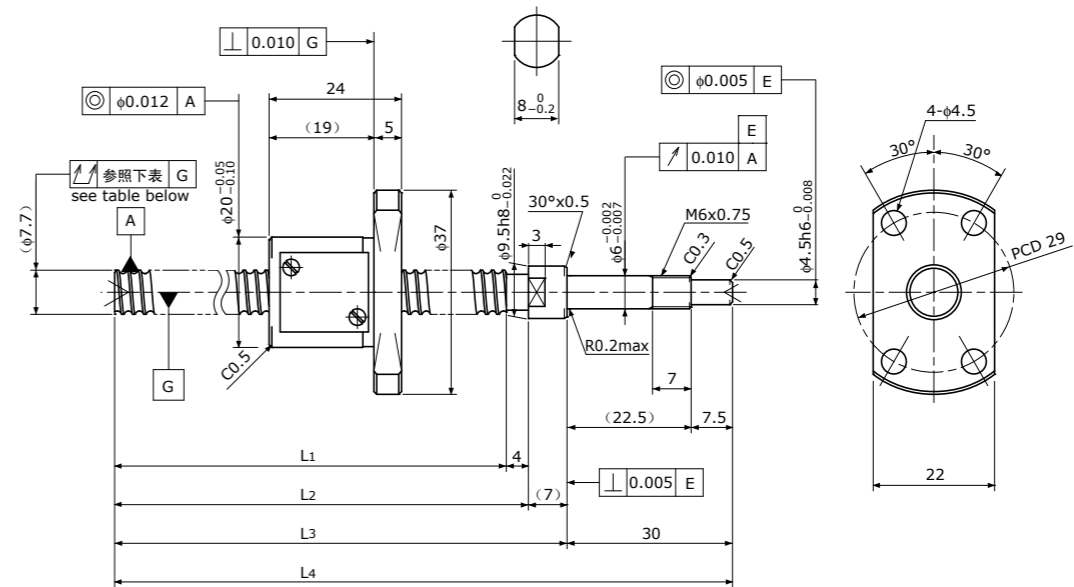

Unit (单位) : mm

Ball Screw Specifications 规格		
Ball size 钢珠直径		$\phi 1.5875$
Number of thread 螺纹条数		1
Thread direction 螺纹方向		Right 右
Shaft root dia. 丝杠轴低径		$\phi 6.6$
Number of circuit 循环数		$3.7 \times 1$
Material 材质	Shaft 轴	S55C + SUS303
	Nut 螺母	SCM415H
Surface hardness 螺纹部表面硬度		HRC58~ (Thread area)
Lubrication 润滑剂		KSS Original Grease MSG No.2

Supported-side end-journal profile 支撑侧轴端加工形状

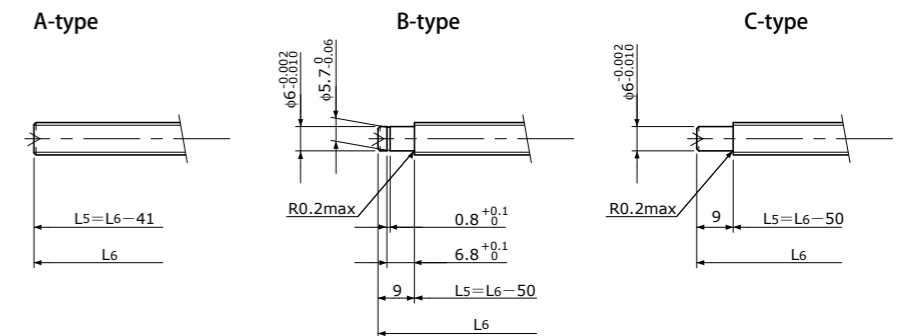
L5: Thread length after end-journal machining. 追加工后的螺纹部长度  
L6: Total length after end-journal machining. 追加工后的总长

Support-unit Recommendation 推荐的支撑单元	Supported-side 支撑侧		Fixed-side 固定侧
		MSU-6CS/6GS, EF6	

D-type: Other than the above. 上述以外的形状

Unit (单位) : mm

Ball Screw Model 滚珠丝杠型号	Travel 行程	Shaft length 丝杠轴长度				Travel deviation 代表移动量误差 $e_p$	Total Run-out 全跳动 $\uparrow$	Axial play 轴向间隙	Basic Load Rating 基本额定负载 N	
		$L_1$	$L_2$	$L_3$	$L_4$				Dynamic 额定动负载 $C_a$	Static 额定静负载 $C_{0a}$
PSRT0802-169R210C5	140	169	173	180	210	$\pm 0.020$	0.065	$\sim 0.005$	2400	4100

Note) Please refer to page A-321 for order code of end-journal machining. 注) 追加工的公称型号指定方法, 请参照A-321页

Standard products in stock PSR series  
标准库存品 PSR系列

PSR0802K

Compact Nut / 紧凑型螺母  
Shaft dia. (轴径)  $\phi 8$  Lead (导程) 2mm

C5

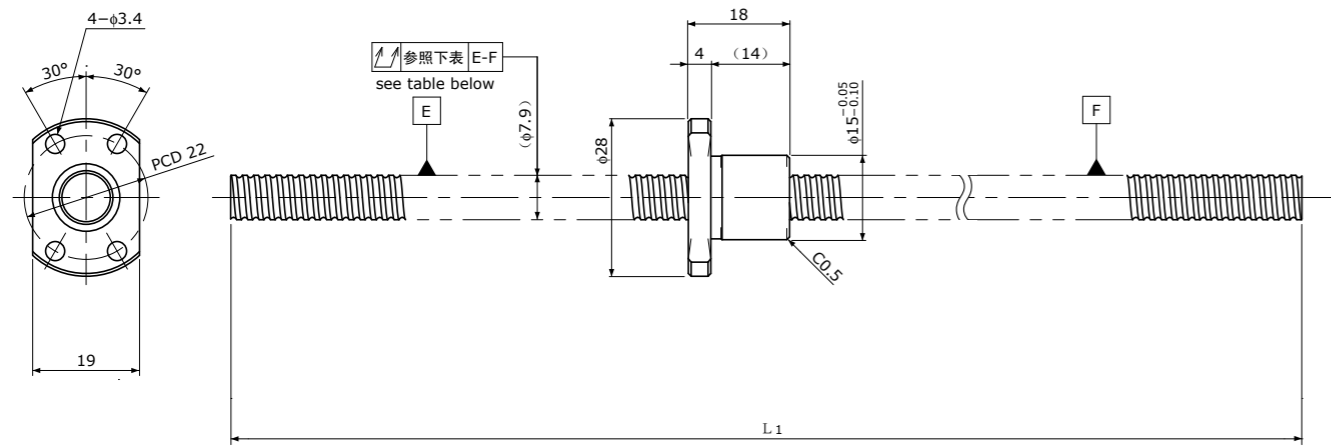

Unit (单位) : mm

Ball Screw Specifications 规格		
Ball size 钢珠直径		$\phi 1.2$
Number of thread 螺纹条数		1
Thread direction 螺纹方向		Right 右
Shaft root dia. 丝杠轴低径		$\phi 7.0$
Number of circuit 循环数		1×3
Material 材质	Shaft 轴	S55C
	Nut 螺母	SCM415H
Surface hardness 螺纹部表面硬度		HRC58~ (Thread area)
Anti-rust treatment 防锈处理		Anti-rust oil 防锈油

Unit (单位) : mm

Ball Screw Model 滚珠丝杠型号	Travel 行程	Shaft length 丝杠轴长度 $L_1$	Travel deviation 代表移动量误差 $e_p$	Total Run-out 全跳动 $\uparrow$	Axial play 轴向间隙	Basic Load Rating 基本额定负载 N	
						Dynamic 额定动负载 $C_a$	Static 额定静负载 $C_{0a}$
PSR0802K-230R230C5	205	230	$\pm 0.023$	0.065	$\sim 0.005$	1300	2300

Note) Please designate end-journal profile with your sketch. 注) 轴端追加工请提供图纸。

Standard products in stock PSRT series  
标准库存品 PSRT系列

PSRT0802K

Compact Nut / 紧凑型螺母  
Shaft dia. (轴径)  $\phi 8$  Lead (导程) 2mm

C5

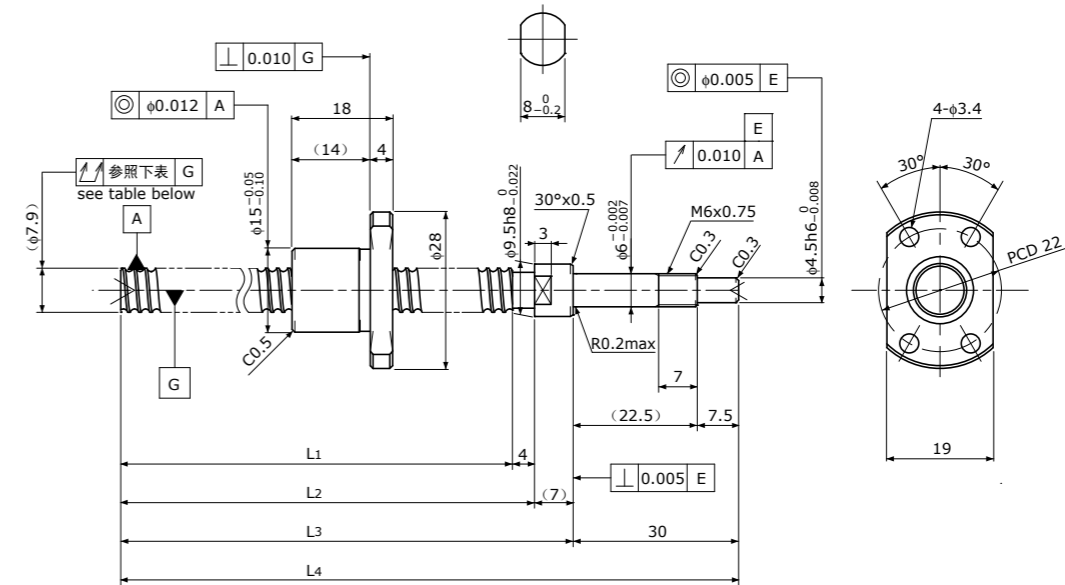

Unit (单位) : mm

Ball Screw Specifications 规格		
Ball size 钢珠直径		$\phi 1.2$
Number of thread 螺纹条数		1
Thread direction 螺纹方向		Right 右
Shaft root dia. 丝杠轴低径		$\phi 7.0$
Number of circuit 循环数		1×3
Material 材质	Shaft 轴	S55C + SUS303
	Nut 螺母	SCM415H
Surface hardness 螺纹部表面硬度		HRC58~ (Thread area)
Lubrication 润滑剂		KSS Original Grease MSG No.2

Supported-side end-journal profile 支撑侧轴端加工形状

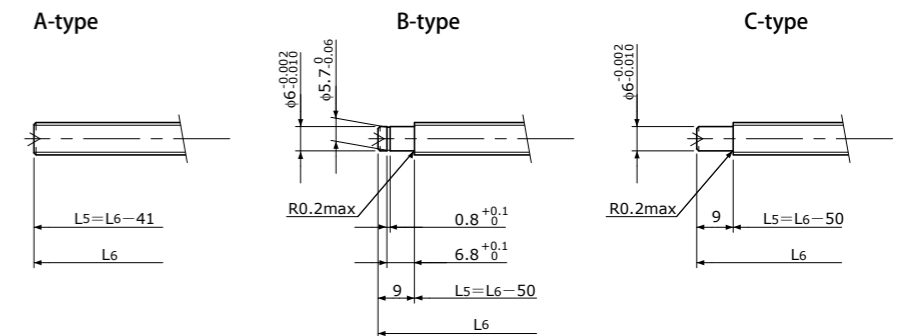
L5: Thread length after end-journal machining. 追加工后的螺纹部长度  
L6: Total length after end-journal machining. 追加工后的总长

Support-unit Recommendation 推荐的支撑单元	Supported-side 支撑侧	
	Fixed-side 固定侧	MSU-6CS/6GS, EF6

D-type: Other than the above. 上述以外的形状

Unit (单位) : mm

Ball Screw Model 滚珠丝杠型号	Travel 行程	Shaft length 丝杠轴长度				Travel deviation 代表移动量误差 $e_p$	Total Run-out 全跳动 $\uparrow$	Axial play 轴向间隙	Basic Load Rating 基本额定负载 N	
		L1	L2	L3	L4				Dynamic 额定动负载 $C_a$	Static 额定静负载 $C_{0a}$
PSRT0802K-169R210C5	145	169	173	180	210	$\pm 0.020$	0.065	$\sim 0.005$	1300	2300

Note) Please refer to page A-321 for order code of end-journal machining. 注) 追加工的公称型号指定方法, 请参照A-321页



Standard products in stock PSR series  
标准库存品 PSR系列

PSR1002K

Compact Nut / 紧凑型螺母  
Shaft dia. (轴径)  $\phi 10$  Lead (导程) 2mm

C5

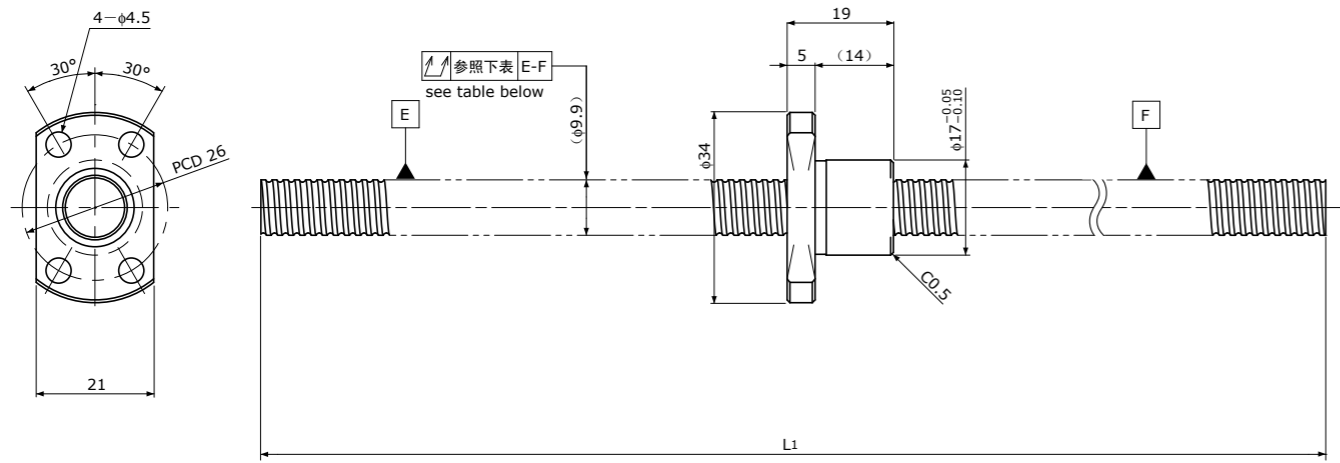

Unit (单位) : mm

Ball Screw Specifications		规格
Ball size 钢珠直径		$\phi 1.2$
Number of thread 螺纹条数		1
Thread direction 螺纹方向		Right 右
Shaft root dia. 丝杠轴低径		$\phi 9.0$
Number of circuit 循环数		1×3
Material 材质	Shaft 轴	S55C
	Nut 螺母	SCM415H
Surface hardness 螺纹部表面硬度		HRC58~ (Thread area)
Anti-rust treatment 防锈处理		Anti-rust oil 防锈油

Unit (单位) : mm

Ball Screw Model 滚珠丝杠型号	Travel 行程	Shaft length 丝杠轴长度 $L_1$	Travel deviation 代表移动量误差 $e_p$	Total Run-out 全跳动 $\uparrow$	Axial play 轴向间隙	Basic Load Rating 基本额定负载 N	
						Dynamic 额定动负载 $C_a$	Static 额定静负载 $C_{0a}$
PSR1002K-230R230C5	205	230	$\pm 0.023$	0.055	$\sim 0.005$	1450	3000

Note) Please designate end-journal profile with your sketch. 注) 轴端追加工请提供图纸。

Standard products in stock PSRT series  
标准库存品 PSRT系列

PSRT1002K

Compact Nut / 紧凑型螺母  
Shaft dia. (轴径)  $\phi 10$  Lead (导程) 2mm

C5

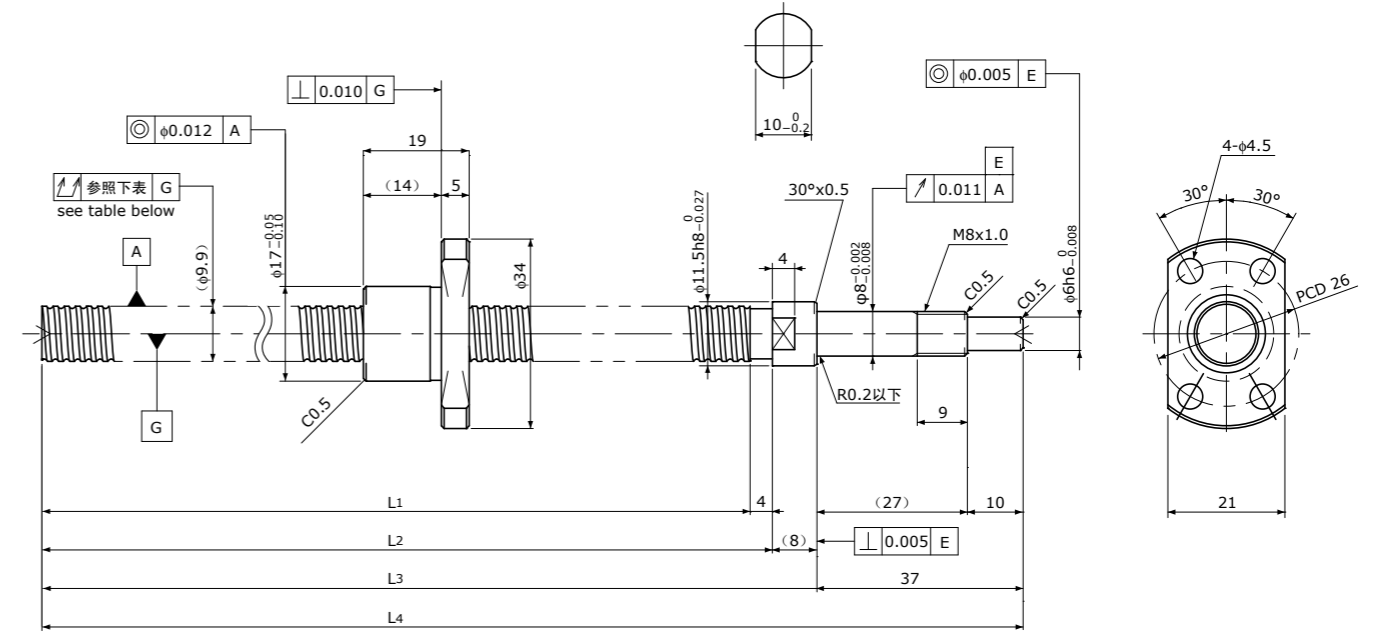

Unit (单位) : mm

Ball Screw Specifications		规格
Ball size 钢珠直径		$\phi 1.2$
Number of thread 螺纹条数		1
Thread direction 螺纹方向		Right 右
Shaft root dia. 丝杠轴低径		$\phi 9.0$
Number of circuit 循环数		1×3
Material 材质	Shaft 轴	S55C + SUS303
	Nut 螺母	SCM415H
Surface hardness 螺纹部表面硬度		HRC58~ (Thread area)
Lubrication 润滑剂		KSS Original Grease MSG No.2

## Supported-side end-journal profile 支撑侧轴端加工形状

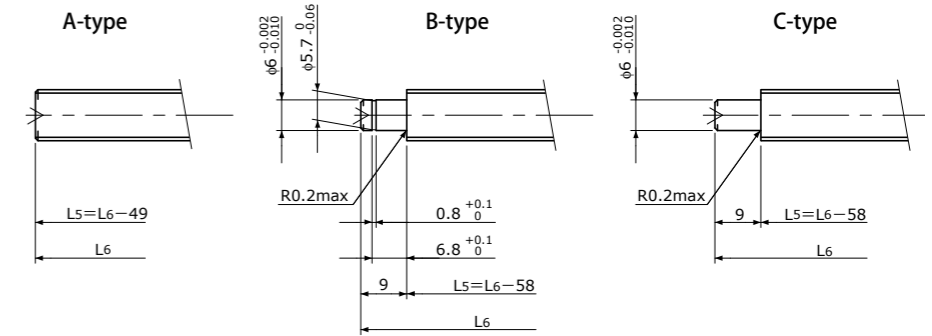
L5: Thread length after end-journal machining. 追加工后的螺纹部长度  
L6: Total length after end-journal machining. 追加工后的总长

Support-unit Recommendation 推荐的支撑单元	Supported-side 支撑侧	Fixed-side 固定侧
	MSU-8CS/8GS, EF8	MSU-8C/8G, EK8

D-type: Other than the above. 上述以外的形状

Unit (单位) : mm

Ball Screw Model 滚珠丝杠型号	Travel 行程	Shaft length 丝杠轴长度				Travel deviation 代表移动量误差 $e_p$	Total Run-out 全跳动 $\uparrow$	Axial play 轴向间隙	Basic Load Rating 基本额定负载 N	
		L1	L2	L3	L4				Dynamic 额定动负载 $C_a$	Static 额定静负载 $C_{0a}$
PSRT1002K-201R250C5	175	201	205	213	250	$\pm 0.023$	0.055	$\sim 0.005$	1450	3000

Note) Please refer to page A-321 for order code of end-journal machining. 注) 追加工的公称型号指定方法, 请参照A-321页

Standard products in stock PSR series  
标准库存品 PSR系列

PSR1202K

Compact Nut / 紧凑型螺母  
Shaft dia. (轴径)  $\phi 12$  Lead (导程) 2mm

C5

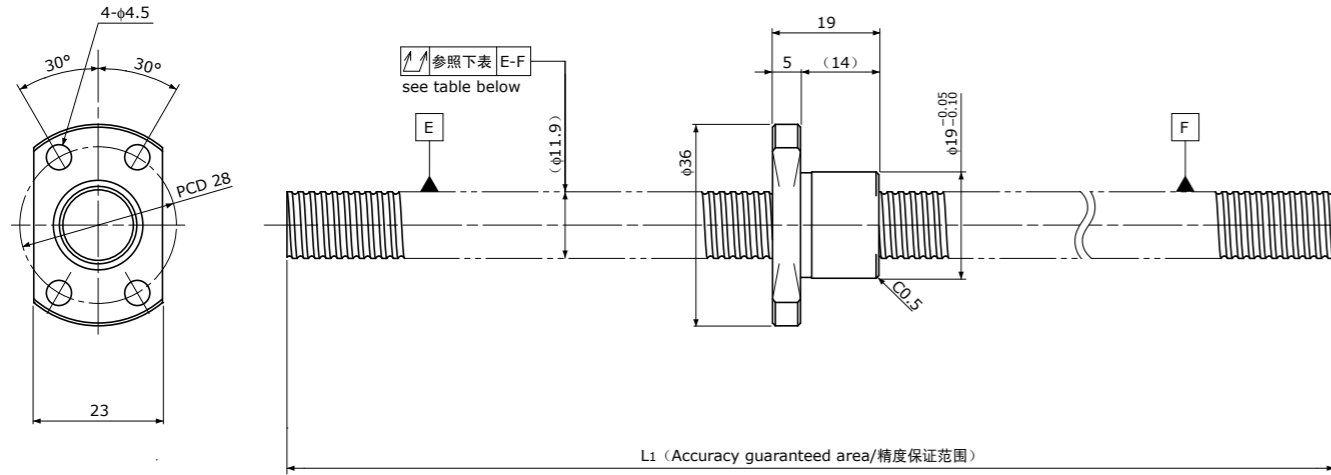

Unit (单位) : mm

Ball Screw Specifications 规格		规格
Ball size 钢珠直径		$\phi 1.2$
Number of thread 螺纹条数		1
Thread direction 螺纹方向		Right 右
Shaft root dia. 丝杠轴低径		$\phi 11.0$
Number of circuit 循环数		1×3
Material 材质	Shaft 轴	S55C
	Nut 螺母	SCM415H
Surface hardness 螺纹部表面硬度		HRC58~ (Thread area)
Anti-rust treatment 防锈处理		Anti-rust oil 防锈油

Unit (单位) : mm

Ball Screw Model 滚珠丝杠型号	Travel 行程	Shaft length 丝杠轴长度		Travel deviation 代表移动量误差 $e_p$	Total Run-out 全跳动 $\uparrow$	Axial play 轴向间隙	Basic Load Rating 基本额定负载 N	
		L <sub>1</sub>					Dynamic 额定动负载 Ca	Static 额定静负载 Coa
PSR1202K-280R280C5	255	280		$\pm 0.023$	0.055	$\sim 0.005$	1600	3700

Note) Please designate end-journal profile with your sketch. 注) 轴端追加工请提供图纸。

Standard products in stock PSRT series  
标准库存品 PSRT系列

PSRT1202K

Compact Nut / 紧凑型螺母  
Shaft dia. (轴径)  $\phi 12$  Lead (导程) 2mm

C5

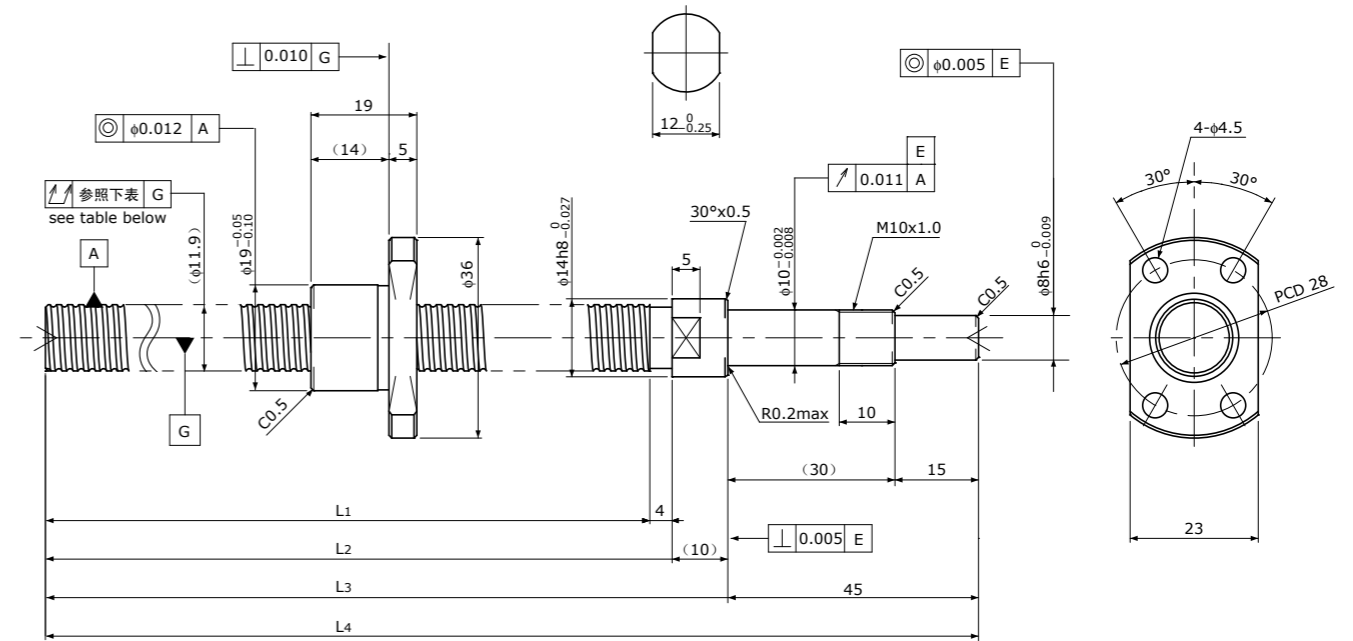

Unit (单位) : mm

Ball Screw Specifications 规格		规格
Ball size 钢珠直径		$\phi 1.2$
Number of thread 螺纹条数		1
Thread direction 螺纹方向		Right 右
Shaft root dia. 丝杠轴低径		$\phi 11.0$
Number of circuit 循环数		1×3
Material 材质	Shaft 轴	S55C+SUS303
	Nut 螺母	SCM415H
Surface hardness 螺纹部表面硬度		HRC58~ (Thread area)
Lubrication 润滑剂		KSS Original Grease MSG No.2

Supported-side end-journal profile 支撑侧轴端加工形状

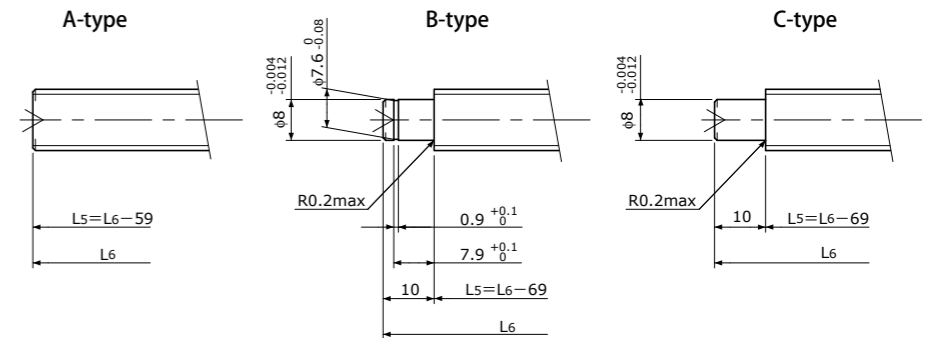

L<sub>5</sub>: Thread length after end-journal machining. 追加工后的螺纹部长度  
L<sub>6</sub>: Total length after end-journal machining. 追加工后的总长

Support-unit Recommendation 推荐的支撑单元	Supported-side 支撑侧	Fixed-side 固定侧
	EF10	EK10

D-type: Other than the above. 上述以外的形状

Unit (单位) : mm

Ball Screw Model 滚珠丝杠型号	Travel 行程	Shaft length 丝杠轴长度				Travel deviation 代表移动量误差 $e_p$	Total Run-out 全跳动 $\uparrow$	Axial play 轴向间隙	Basic Load Rating 基本额定负载 N	
		L <sub>1</sub>	L <sub>2</sub>	L <sub>3</sub>	L <sub>4</sub>				Dynamic 额定动负载 Ca	Static 额定静负载 Coa
PSRT1202K-271R330C5	245	271	275	285	330	$\pm 0.023$	0.065	$\sim 0.005$	1600	3700

Note) Please refer to page A-321 for order code of end-journal machining. 注) 追加工的公称型号指定方法, 请参照A-321页