

SG0610

Shaft dia. $\phi 6$ Lead 10mm

C5

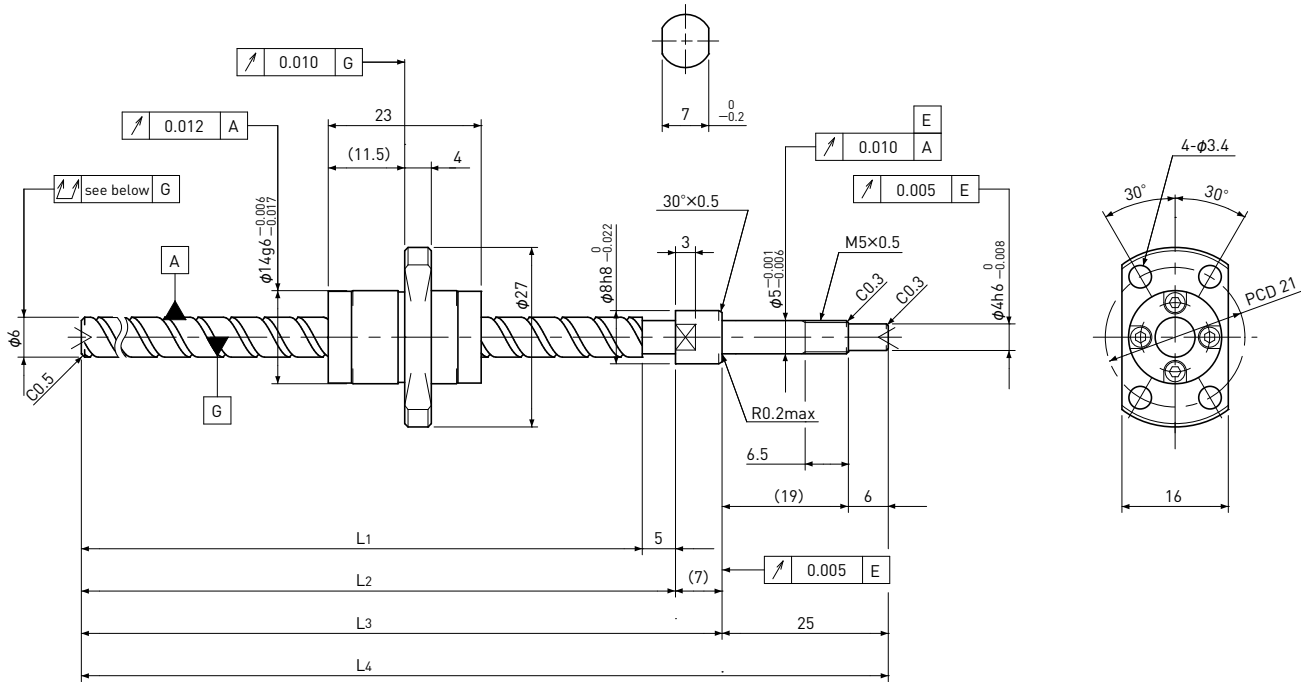

Unit: mm

Ball Screw Specifications	
Ball size	$\phi 1.2$
Number of thread	2
Thread direction	Right
Shaft root dia.	$\phi 5.0$
Number of circuit	1.2×2
Shaft, Nut material	SCM415H
Surface hardness	HRC58~62 (Thread area)
Anti-rust treatment	Anti-rust oil

Supported-side end-journal profile

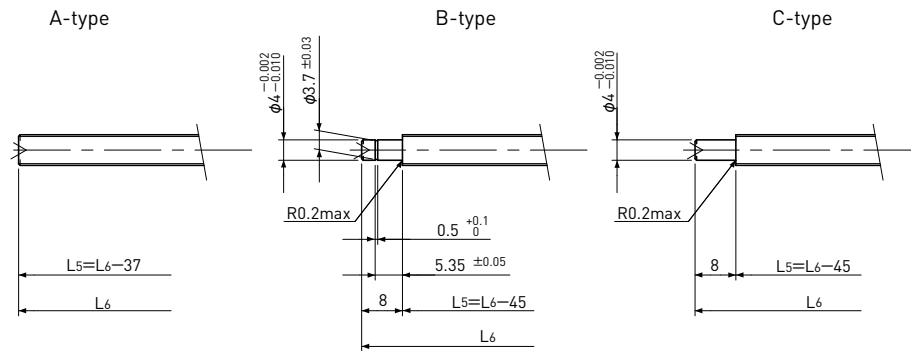

L₅: Thread length after end-journal machining.
L₆: Total length after end-journal machining.

Support-unit Recommendation	Supported-side	Fixed-side
	MSU-5CS/5GS	MSU-5C/5G

D-type : Other than the above.

Unit: mm

Ball Screw Model	Travel	Grade	Shaft length				Lead accuracy		Total Run-out	Axial play	Preload Torque Nm	Basic Load Rating N	
			L ₁	L ₂	L ₃	L ₄	Travel deviation e _p	Variation V _u				Dynamic Ca	Static Coa
SG0610-133R170C5	110	C5	133	138	145	170	±0.020	0.018	0.050	~0.005	—	950	1600

Note) Please refer to page A206 for order code of end-journal machining.