

SR1510

Shaft dia. $\phi 15$ Lead 10mm

Ct10

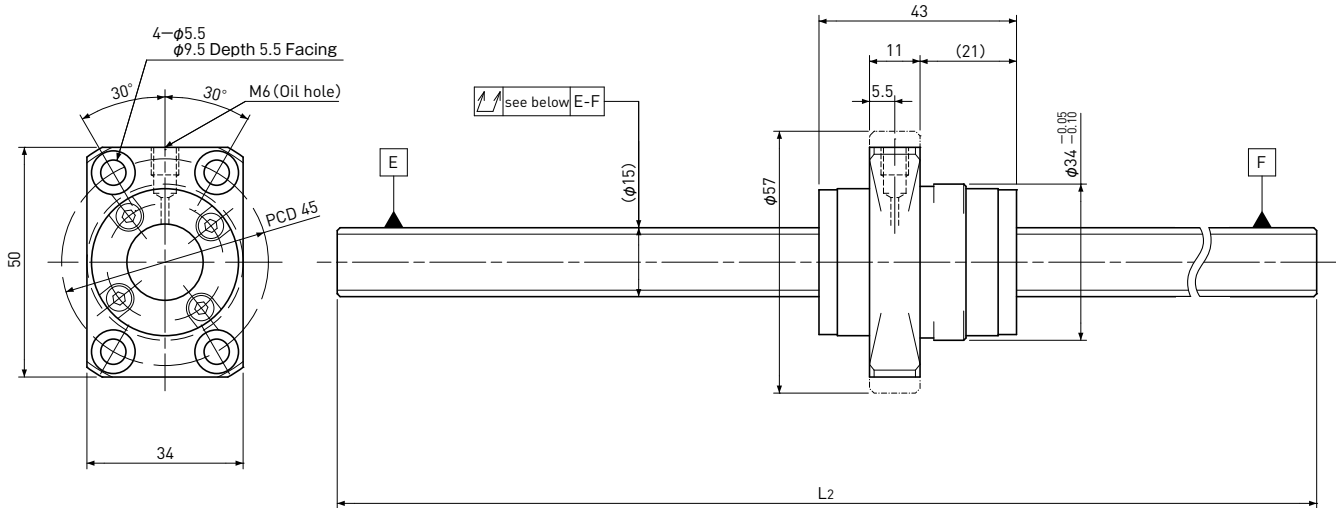

Unit: mm

Ball Screw Specifications		
Ball size	$\phi 3.175$	
Number of thread	2	
Thread direction	Right	
Shaft root dia.	$\phi 12.2$	
Number of circuit	2.7×2	
Material	Shaft	SUJ2
	Nut	SCM415
Surface hardness	HRC58~62 (Thread area)	
Anti-rust treatment	Anti-rust oil	

Unit: mm

Ball Screw Model	Travel	Grade	Shaft length		Lead accuracy		Total Run-out	Axial play	Preload Torque Nm	Basic Load Rating N	
			L ₁	L ₂	Travel deviation e_p	Variation V_{300}				Dynamic Ca	Static Coa
SR1510-1000R1000C10	955	Ct10	—	1000	± 0.7	0.21	0.400	~0.050	—	12000	25000

Note) Please designate end-journal profile with your sketch.