

Rolled Ball Screw + 5-Phase Stepping Motor

# TMB □42 / NEMA 17

Shaft dia.  $\phi 8$

[TMB0805]

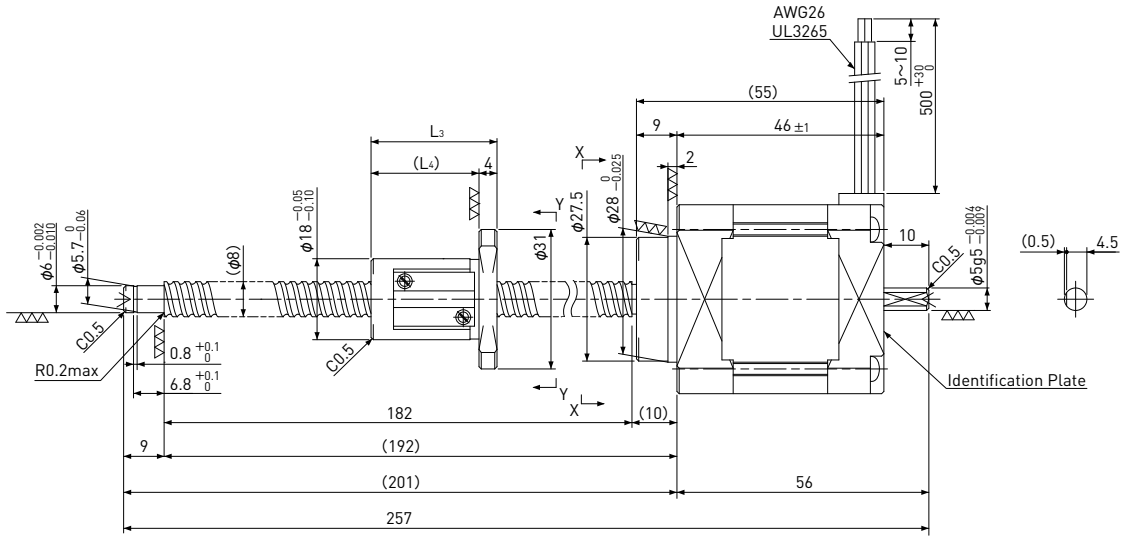

[TMB0812]

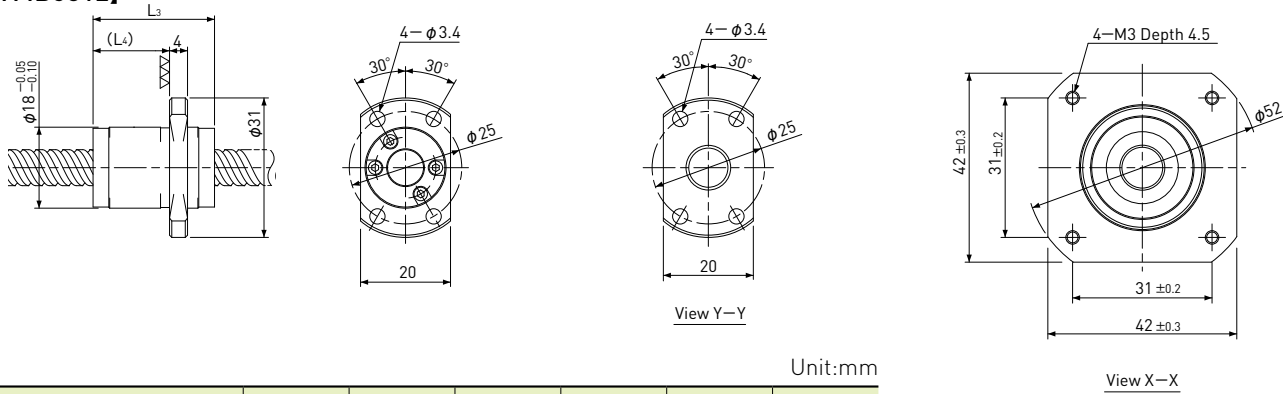

Unit:mm

Model	Lead	Travel	Reference Thrust (N)	L <sub>3</sub>	L <sub>4</sub>	Mass (g)
TMB0805	5	150	120	28	24	450
TMB0812	12	150	50	27	17	450

Recommended Drivers	KR-A5CC
	KR-A55MC(Micro step)
	KR-A535M(Micro step / AC-100~220V)

Note) Refer to page P162 or P163 for connection diagram of recommended Drivers.

Ball Screw Specifications	
Accuracy grade	JIS Ct7
Thread direction	Right
Axial play	0.020mm or less
Shaft & Nut material	Chrome-molybdenum steel
Surface Coating	Black Chrome coating on Shaft
Surface hardness	HRC58~62 (Thread area)
Lubricant	KSS original grease MSG No.1

Motor Specifications	
Basic step angle	0.72°
Rated Voltage	DC 1.65 V
Rated current	DC 0.75 A/phase
Winding resistance	2.0Ω
Holding Torque	0.236Nm
Rotor inertia	74g·cm <sup>2</sup>
Operating temperature	-20°C~50°C

Note) Only shaft end cutting is available. Other than that, it would be customized order.